

## A61H

**PHYSICAL THERAPY APPARATUS, e.g. DEVICES FOR LOCATING OR STIMULATING REFLEX POINTS IN THE BODY; ARTIFICIAL RESPIRATION; MASSAGE; BATHING DEVICES FOR SPECIAL THERAPEUTIC OR HYGIENIC PURPOSES OR SPECIFIC PARTS OF THE BODY (electrotherapy, magnetotherapy, radiation therapy, ultrasound therapy [A61N](#))**

### Definition statement

*This place covers:*

Apparatus or processes which are not used for surgical purposes utilizing mechanical energy transmitted by direct physical contact with the external surface of the thorax portion of human bodies to induce or supplement normal breathing (e.g. iron lungs).

Apparatus or processes, which are not used for surgical purposes that are specially adapted to improve or promote the optical functioning of individuals (e.g. rectify defective vision, improve the natural operation of their eyes) by:

- contacting eyes or their muscles directly to move the eyes,
- subjecting the eyes of individuals to controlled muscle strain,
- utilizing stimulators, such as flash illumination, to cause movement of eyes of individuals in a controlled manner, or
- facilitating or training individuals through practice to move their own eyes in a beneficial manner.

Apparatus or devices that are explicitly designed for use by a single patient or disabled person for the purpose of helping them overcome a physical condition that impairs their ability to walk unassisted across the ground or similar support surface (e.g. crutches).

Apparatus or processes utilizing mechanical energy directly applied upon human bodies for therapy (e.g. massage). These therapy apparatus and processes are intended to facilitate the healing of diseases, promote or assist normal operation of a malfunctioning body part, reduce the impact of injuries, or beneficially influence the condition of disabled body parts either by the physical movement of body parts (e.g. devices for exercising a passive body member) or other types of physical stimulation (e.g. touching) transmitted through contact with:

- external body surfaces or
- surfaces of naturally occurring body cavities.

Apparatus or processes which are not used for surgical purposes utilizing mechanical energy directly applied to human bodies by physical contact therewith (e.g. chiropractic) to treat, alleviate the effects of, or prevent disease or bodily malfunctions (e.g. misalignments of bone, aberrant joint) solely by manipulation, adjustment, or realignment of at least a portion of the skeletal system of the body (e.g. bone joints, tendons, spinal columns) by either:

- impacting external surfaces of bodies to manipulate or adjust portions of their skeletons containing unbroken bones or
- pulling or pushing on the external surfaces of bodies to extend or compress portions of their skeletons containing unbroken bones.

Apparatus or processes which are not used for surgical purposes utilizing mechanical energy directly applied upon human bodies by physical contact (e.g. massage) to rub, stroke, knead, tap, vibrate, or otherwise move a portion of the external surface of human bodies, or the surfaces of their naturally occurring body cavities, to either:

- physically relax individuals,
- physically arouse or stimulate individuals, or
- counteract or relieve bodily pains.

## Definition statement

Apparatus or processes which are not used for surgical purposes (e.g. baths) that are specially adapted for covering, soaking, or immersing human bodies, or portions of bodies, within fluids (e.g. steam, water) or fluent materials (e.g. sand, mud) in a manner that is distinct from the common bathing process for cleaning human bodies and is intended to either:

- counteract or relieve bodily pains,
- physically relax individuals,
- promote or assist healing of injured bodies or their parts, or
- restore to health, or alleviate the effects of sicknesses or other types of abnormal conditions on, bodies or their parts.

Apparatus or processes (e.g. breast baths) specially adapted for covering, soaking, or immersing only one particular part of the human body within fluids (e.g. steam, water) or fluent materials (e.g. sand, seaweed).

Articles of clothing (e.g. sweating suits for therapy) that at least partially enclose human bodies for the primary purpose of increasing the local temperature (e.g. insulated, include heating elements) or humidity (e.g. constructed of partially air tight material) of the portion of the human bodies covered to a point where the localized temperature or humidity is beyond the range that human beings normally consider physically comfortable (i.e. creates localized sauna-like environment) for therapy.

Specially adapted components for the above types of apparatus.

Auxiliary appliances or accessories specially adapted for use with any of the above types of apparatus or process (e.g. reflex point locators).

Other types of apparatus or processes which are not used for surgical (e.g. acupuncture devices) purposes that utilize mechanical energy directly applied to human bodies by physical contact for improving their functioning that are not specifically provided for elsewhere in another subclass.

## Relationships with other classification places

When used with animals

If an apparatus or process is usable for both humans and animals for the same purpose and in the same manner, and it is otherwise proper for this subclass, classification is made only in subclass [A61H](#). Similar devices or processes to those covered by subclass [A61H](#) that are usable exclusively for animals, or are used in animals in a different manner or for different purposes than for humans, are classified in subclass [A61D](#).

When used for physical relaxation

Subclass [A61H](#) covers apparatus or processes that are specially adapted to physically relax or stimulate individuals due either to

- mechanical energy being directly applied upon human body parts to cause their physical movement, or stimulation, by direct physical contact with external surfaces of the body or surfaces of naturally occurring cavities in the body (i.e. massage) or
- the calming or invigorating effects of bathing.

Subclass [A61M](#) covers devices or processes which are specially adapted to cause or precipitate a change in the state of consciousness of humans (e.g. induce sleep, awaken), or to increase or decrease the mental activity of humans while awake, which may also involve relaxing or stimulating individuals.

Medical Treatment

Several subclasses provide for apparatus or processes that are used for treating humans for medical conditions. The relationship between these subclasses is as follows:

Subclass [A61B](#) provides for surgical apparatus or processes in general.

## Relationships with other classification places

Subclass [A61B](#) also provides for surgical apparatus or processes when

- surgical apparatus or processes are combined with means used for other types of treatment (e.g. therapy, massage) for medical conditions or
- the apparatus can be used both for surgery and for other types of treatment for medical conditions.

Subclass [A61H](#) provides for massage, chiropractic, or physical therapy apparatus or processes used for the treatment of disease, injuries, or disability (i.e. an abnormal condition of the body) by utilization of direct mechanical energy.

Subclass [A61N](#) provides for apparatus or processes used for the treatment of disease, injuries, or disability by utilization of forms of energy other than direct mechanical energy.

## References

### Limiting references

*This place does not cover:*

Electrotherapy, magneto therapy, radiation therapy, ultrasound therapy	<a href="#">A61N</a>
--	----------------------

### Application-oriented references

*Examples of places where the subject matter of this place is covered when specially adapted, used for a particular purpose, or incorporated in a larger system:*

Accessory implements for clippers or shavers carrying out massage or other functions than cutting hair	<a href="#">B26B 19/48</a>
--	----------------------------

### Informative references

*Attention is drawn to the following places, which may be of interest for search:*

Training or exercising equipment for animals	<a href="#">A01K 15/02</a>
Garments with controlled internal environment	<a href="#">A41D 13/002</a>
Ventilating, cooling or heating means in connection with bedsteads or mattresses	<a href="#">A47C 21/04</a>
Apparatus for helping babies to walk	<a href="#">A47D 13/04</a>
Baths; Showers; Appurtenances therefore for merely cleaning human bodies	<a href="#">A47K 3/00</a>
Body washing or cleaning implements for merely cleaning human bodies	<a href="#">A47K 7/00</a>
Dental implements for therapeutic treatment	<a href="#">A61C 19/06</a>
Methods or devices enabling patients or disabled persons to operate an apparatus or a device not forming part of the body	<a href="#">A61F 4/00</a>
Orthopaedic devices or methods	<a href="#">A61F 5/00</a>
Devices for treatment of the eyes	<a href="#">A61F 9/00</a>
Means for washing bed-ridden persons	<a href="#">A61G 7/0005</a>
Beds for promoting or observing sleep	<a href="#">A61G 7/05</a>
Sub aquatic intestinal cleaning	<a href="#">A61M 9/00</a>
Devices for influencing the respiratory system of patients by gas treatment, e.g. mouth-to-mouth respiration	<a href="#">A61M 16/00</a>
Devices for producing or ending sleep by mechanical, optical, or acoustical means (other than alarm clocks or the like)	<a href="#">A61M 21/00</a>

Blood pumps or devices for mechanical circulatory assistance	<a href="#">A61M 60/00</a>
Electro medical massage devices applying continuous direct current by contact electrodes	<a href="#">A61N 1/26</a>
Electrotherapy devices applying alternating or intermittent currents by contact electrodes	<a href="#">A61N 1/32</a>
Applying ionized fluids to the human body for therapy	<a href="#">A61N 1/44</a>
Exercising apparatus specially adapted for conditioning the cardio-vascular system, for training agility or co-ordination of movements	<a href="#">A63B 22/00</a>
Exercising apparatus specially adapted for particular parts of the body	<a href="#">A63B 23/00</a>
Exercising devices for feet or toes	<a href="#">A63B 23/10</a>

## Glossary of terms

*In this place, the following terms or expressions are used with the meaning indicated:*

Therapy	Any medical treatment of an abnormal condition of a human or animal body (e.g. disease, impaired organ, injured limb) by means, instruments, devices, or methods that utilize forms of energy (e.g. mechanical energy) and which is not used for surgical purposes. In general, the treatment time for therapy is long-term relative to that for surgery which usually has a much more immediate effect on the body.
Disabled person	A human being that is unable to do a basic physical task (e.g. walking) without assistance due to a physical or mental impairment/condition.
Patient	A human being awaiting or undergoing any form of (a) medical care (e.g. testing) or treatment by medical staff (e.g. doctors, dentists, midwives, chiropractors) or (b) physical tending (e.g. feeding) by care providers (e.g. hospice or nursing home staff) due to impairment.

## BODY PLANES

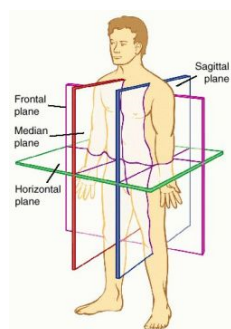

The body-symmetrical plane is also called midsagittal plane or median plane.

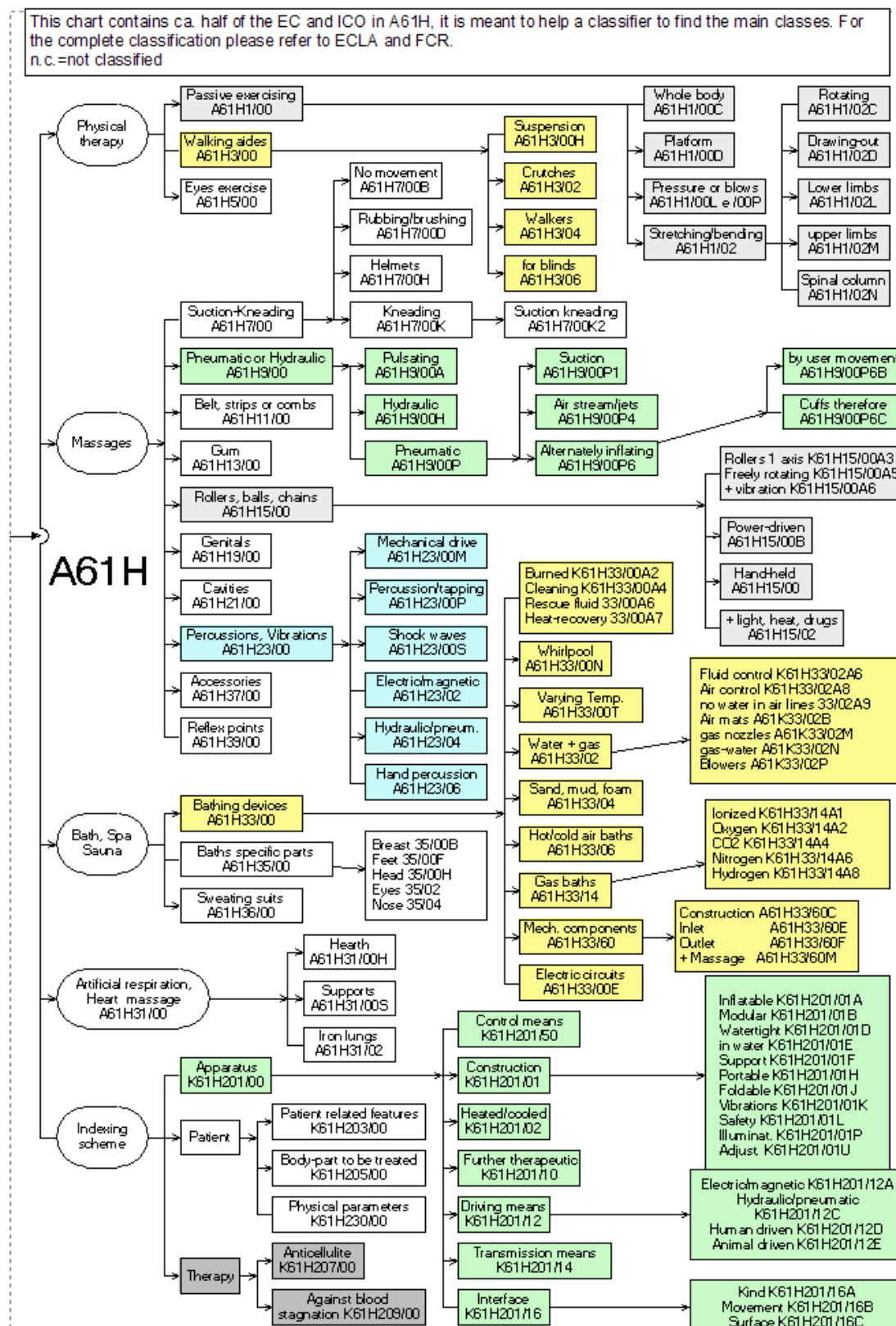

The preceding image includes references to [A61H](#), [A61H 1/00](#), [A61H 3/00](#), [A61H 5/00](#), [A61H 7/00](#), [A61H 9/00](#), [A61H 11/00](#), [A61H 13/00](#), [A61H 15/00](#), [A61H 19/00](#), [A61H 21/00](#), [A61H 23/00](#), [A61H 37/00](#), [A61H 39/00](#), [A61H 33/00](#), [A61H 35/00](#), [A61H 36/00](#), [A61H 31/00](#), [K61H201/00](#), [A61H7/00B](#), [A61H7/00D](#), [A61H7/00H](#), [A61H7/00K](#), [A61H9/00A](#), [A61H9/00H](#), [A61H9/00P](#),

**A61H23/00M, A61H23/00P, A61H23/00S, A61L23/02, [A61H 23/04](#), [A61H 23/06](#), 35/00B, 35/00F, 35/00H, 35/02, 35/04, A61H31/00H, A61H31/00S, [A61H 31/02](#), K61H203/00, H61H205/00, H61H230/00, K61H207/00, K61H209/00, A61H3/00H, [A61H 3/02](#), [A61H 3/04](#), [A61H 3/06](#), A61H7/00K2, A61H9/00P1, A61H9/00P4, A61H9/00P6, K16H33/00A2, K61H33/00A4, 33/00A6, 33/00A7, A61H33/00N, A61H33/00T, [A61H 33/02](#), [A61H 33/04](#), [A61H 33/06](#), [A61H 33/14](#), [A61H 33/60](#), A61H33/00E, K61H201/50, K61H201/01, K61H201/02, K61H201/10, K61H201/12, K61H201/14, K61H201/16, A61H1/00C, A61H1/00D, A61H1/00L, /00P, [A61H 1/02](#), A61H1/02C, A61H1/02D, A61H1/02L, A61H1/02M, A61H1/02N, A61H9/00P6B, A61H9/00P6C, K61H15/00A3, K61H15/00A5, K61H15/00A6, A61H15/00B, [A61H 15/00](#), [A61H 15/02](#), K61H33/02A6, K61H33/02A8, 33/02A9, A61K33/02B, A61K33/02M, A61K33/02N, A61K33/02P, K61H33/14A1, K61H33/14A2, K61H33/14A4, K61H33/14A6, K61H33/14A8, A61H33/60C, A61H33/60E, A61H33/60F, A61H33/60M, K61H201/01A, K61H201/01B, K61H201/01D, K61H201/01E, K61H201/01F, K61H201/01H, K61H201/01J, K61H201/01K, K61H201/01L, K61H201/01P, K61H201/01U, K61H201/12A, K61H201/12C, K61H201/12D, K61H201/12E, K61H201/16A, K61H201/16B, K61H201/16C**

## **A61H 1/00**

**Apparatus for passive exercising ([A61H 5/00](#) takes precedence); Vibrating apparatus {(driving means for vibrating [A61H 23/00](#))}; Chiropractic devices, e.g. body impacting devices, external devices for briefly extending or aligning unbroken bones**

### **Definition statement**

*This place covers:*

Apparatus and processes intended to facilitate the healing of diseases, promote or assist normal operation of a malfunctioning body part, reduce the impact of injuries, or beneficially influence the condition of disabled body parts either by the physical movement of body parts (e.g. devices for exercising a passive body member) or other types of physical stimulation (e.g. pressure or blows on a part of the skeletal structure, vibration on the body).

Vibrating apparatus for passive exercising.

### **References**

#### **Limiting references**

*This place does not cover:*

Exercisers for the eyes	<a href="#">A61H 5/00</a>
Percussion or vibration massaging means	<a href="#">A61H 23/00</a>

#### **Informative references**

*Attention is drawn to the following places, which may be of interest for search:*

Active exercising has to be classified in [A63B](#)

### **Special rules of classification**

The driving means for vibrating are classified in [A61H 23/00](#)

For additional information the orthogonal classification ([A61H 2201/00](#), [A61H 2230/855](#)) is used.

**A61H 1/001****{Apparatus for applying movements to the whole body}****References****Informative references***Attention is drawn to the following places, which may be of interest for search:*

Incorporated in furniture	<a href="#">A61H 2201/0138</a>
Driving means	<a href="#">A61H 2201/12</a>

**A61H 1/003****{Rocking or oscillating around a horizontal axis transversal to the body}****References****Limiting references***This place does not cover:*

Oscillating beds	<a href="#">A47C 21/006</a> , <a href="#">A47D 9/02</a> , <a href="#">B62B 9/22</a>
------------------	--

**Informative references***Attention is drawn to the following places, which may be of interest for search:*

For artificial respiration or heart stimulation	<a href="#">A61H 31/00</a>
---	----------------------------

**A61H 1/005****{Moveable platform, e.g. vibrating or oscillating platform for standing, sitting, laying, leaning}****References****Informative references***Attention is drawn to the following places, which may be of interest for search:*

Incorporated in furniture	<a href="#">A61H 2201/0138</a>
Portable	<a href="#">A61H 2201/0157</a>
Size reducing arrangement when not in use	<a href="#">A61H 2201/0161</a>

**Special rules of classification**Vibration driving means are classified in [A61H 23/00](#)

**A61H 1/006**

{Apparatus for applying pressure or blows for compressive stressing of a part of the skeletal structure, e.g. for preventing or alleviating osteoporosis}

**References****Limiting references**

*This place does not cover:*

Chiropractic tables	<a href="#">A61G 13/009</a>
---------------------	-----------------------------

**A61H 1/008**

{Apparatus for applying pressure or blows almost perpendicular to the body or limb axis, e.g. chiropractic devices for repositioning vertebrae, correcting deformation}

**Definition statement**

*This place covers:*

Apparatus for chiropractic manipulation of the body of a user

**References****Limiting references**

*This place does not cover:*

Percussion or tapping massage	<a href="#">A61H 23/006</a>
-------------------------------	-----------------------------

**Informative references**

*Attention is drawn to the following places, which may be of interest for search:*

Driving means	<a href="#">A61H 2201/12</a>
---------------	------------------------------

**A61H 1/02**

Stretching or bending {or torsioning} apparatus for exercising

**References****Limiting references**

*This place does not cover:*

Device suitable for active OR passive exercising	<a href="#">A63B 21/00178</a>
Electric motor for active or passive exercising	<a href="#">A63B 21/0058</a>

**Informative references**

*Attention is drawn to the following places, which may be of interest for search:*

Driving means	<a href="#">A61H 2201/12</a>
Interface with user	<a href="#">A61H 2201/16</a>



Position of user	<a href="#">A61H 2203/04</a>
------------------	------------------------------

## A61H 2001/0203

{Rotation of a body part around its longitudinal axis}

### References

#### Informative references

Attention is drawn to the following places, which may be of interest for search:

for active exercising	<a href="#">A63B 2023/003</a>
-----------------------	-------------------------------

## A61H 2001/0207

{Nutating movement of a body part around its articulation}

### Definition statement

*This place covers:*

rocking, swaying, or nodding motion in the axis of rotation of a largely axially symmetric object, e.g. circular movement around a joint.

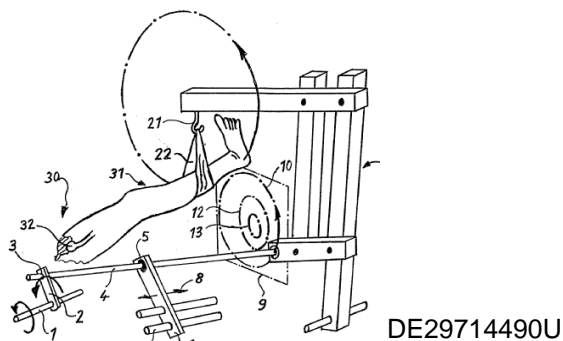

## A61H 2001/0211

{Walking coordination of arms and legs}

### References

#### Informative references

Attention is drawn to the following places, which may be of interest for search:

Walking movement for legs	<a href="#">A61H 1/0262</a>
---------------------------	-----------------------------

**A61H 1/0214****{by rotating cycling movement}****References****Informative references***Attention is drawn to the following places, which may be of interest for search:*

Rotating interface	<a href="#">A61H 2201/1671</a>
Device suitable for active OR passive exercising	<a href="#">A63B 21/00178</a>
Assisted exercising	<a href="#">A63B 21/00181</a>
for active exercising	<a href="#">A63B 22/06</a>

**A61H 1/0218****{Drawing-out devices (suspension devices for supporting the patient in upright walking or standing position [A61H 3/008](#); orthopedic devices for non-surgical treatment [A61F 5/01](#); stretching fractured limbs [A61F 5/04](#))}****References****Informative references***Attention is drawn to the following places, which may be of interest for search:*

Suspension devices for supporting in a standing position	<a href="#">A61H 3/008</a>
Driving means	<a href="#">A61H 2201/12</a>
Interface with user	<a href="#">A61H 2201/16</a>
Control means	<a href="#">A61H 2201/50</a>
Position of user	<a href="#">A61H 2203/04</a>
Orthopaedic devices for non-surgical treatment	<a href="#">A61F 5/00</a>
Stretching fractured limbs	<a href="#">A61F 5/04</a>
Interface with user for active exercising	<a href="#">A63B 21/40</a>

**A61H 1/0222****{Traction tables ([A61H 1/0229](#) take precedence)}****References****Informative references***Attention is drawn to the following places, which may be of interest for search:*

by hanging the patient upside down or inclined downwardly	<a href="#">A61H 2203/0493</a>
---	--------------------------------

**A61H 1/0229**

{by reducing gravity forces normally applied to the body, e.g. by lifting or hanging the body or part of it}

**References****Limiting references**

*This place does not cover:*

Suspension devices for a walking or standing position	<a href="#">A61H 3/008</a>
---	----------------------------

**Informative references**

*Attention is drawn to the following places, which may be of interest for search:*

Patient immersed in liquid	<a href="#">A61H 2203/02</a>
Patient hanging	<a href="#">A61H 2203/0481</a>

**A61H 2001/0233**

{Pulsating, alternating, fluctuating}

**References****Informative references**

*Attention is drawn to the following places, which may be of interest for search:*

Percussion or vibration means	<a href="#">A61H 23/00</a>
other driving means	<a href="#">A61H 2201/12</a>

**A61H 1/0237**

{for the lower limbs}

**Definition statement**

*This place covers:*

devices specifically made for stretching or bending passively a joint for therapy or for supporting the movement of a joint of a disabled person in a daily activity.

**References****Informative references**

*Attention is drawn to the following places, which may be of interest for search:*

for aiding disabled persons to walk	<a href="#">A61H 3/00</a>
Interface for lower limbs	<a href="#">A61H 2201/164</a>
Therapy devices for lower limbs	<a href="#">A61H 2205/10</a>

**A61H 1/024**{Knee ([A61H 1/0255](#) takes precedence)}**References****Informative references***Attention is drawn to the following places, which may be of interest for search:*

Interface for lower limbs	<a href="#">A61H 2201/164</a>
Therapy devices for knees	<a href="#">A61H 2205/104</a>

**A61H 1/0244**{Hip ([A61H 1/0255](#) takes precedence)}**References****Informative references***Attention is drawn to the following places, which may be of interest for search:*

Interface for the pelvis	<a href="#">A61H 2201/1628</a>
Therapy devices for hip	<a href="#">A61H 2205/088</a>

**A61H 2001/0248**

{by separating the legs laterally}

**References****Informative references***Attention is drawn to the following places, which may be of interest for search:*

Device suitable for active OR passive exercising	<a href="#">A63B 21/00178</a>
Assisted exercising	<a href="#">A63B 21/00181</a>
for active exercising	<a href="#">A63B 23/0488</a>

**A61H 2001/0251**

{by moving the legs together laterally}

**References****Informative references***Attention is drawn to the following places, which may be of interest for search:*

Position of the patient	<a href="#">A61H 2203/04</a>
-------------------------	------------------------------

**A61H 1/0255**

{Both knee and hip of a patient, e.g. in supine or sitting position, the feet being moved in a plane substantially parallel to the body-symmetrical-plane ([A61H 1/0214](#) takes precedence)}

**References****Limiting references**

*This place does not cover:*

rotating cycling movement	<a href="#">A61H 1/0214</a>
standing-up or sitting down aids	<a href="#">A61G 5/14</a>

**Informative references**

*Attention is drawn to the following places, which may be of interest for search:*

Position of the patient	<a href="#">A61H 2203/04</a>
Device suitable for active OR passive exercising	<a href="#">A63B 21/00178</a>
Assisted exercising	<a href="#">A63B 21/00181</a>
for active exercising	<a href="#">A63B 23/0405</a>

**A61H 1/0259**

{moved by translation}

**Special rules of classification**

This therapy is typically performed in a supine position, therefore the position supine [A61H 2203/0456](#) does not need to be classified, only different positions are classified.

**A61H 1/0262**

{Walking movement; Appliances for aiding disabled persons to walk ([A61H 3/00](#) takes precedence)}

**Definition statement**

*This place covers:*

Simulation of the walking movement, or part of it

**References****Limiting references**

*This place does not cover:*

Walking coordination of arms and legs	<a href="#">A61H 2001/0211</a>
Appliances aiding disabled persons to walk	<a href="#">A61H 3/00</a>

**A61H 1/0266****{Foot}****Definition statement***This place covers:*

Also movement of ankle

**References****Informative references***Attention is drawn to the following places, which may be of interest for search:*

Interface for the foot	<a href="#">A61H 2201/164</a>
Therapy devices for the foot	<a href="#">A61H 2205/125</a>
for active exercising	<a href="#">A63B 23/10</a>

**A61H 2001/027****{Toes}****References****Informative references***Attention is drawn to the following places, which may be of interest for search:*

for active exercising	<a href="#">A63B 23/10</a>
-----------------------	----------------------------

**A61H 1/0274****{for the upper limbs}****References****Informative references***Attention is drawn to the following places, which may be of interest for search:*

Interface for the upper limbs	<a href="#">A61H 2201/1635</a>
Therapy devices for the upper limbs	<a href="#">A61H 2205/06</a>
for active exercising	<a href="#">A63B 23/12</a>

**A61H 1/0277****{Elbow}****References****Informative references***Attention is drawn to the following places, which may be of interest for search:*

for active exercising	<a href="#">A63B 23/1281</a>
-----------------------	------------------------------

**A61H 1/0281****{Shoulder}****References****Informative references***Attention is drawn to the following places, which may be of interest for search:*

Interface for shoulders	<a href="#">A61H 2201/1614</a>
Therapy devices for the shoulders	<a href="#">A61H 2205/062</a>
for active exercising	<a href="#">A63B 23/12</a>

**A61H 1/0285****{Hand}****References****Informative references***Attention is drawn to the following places, which may be of interest for search:*

Interface for the hands	<a href="#">A61H 2201/1635</a>
Therapy devices for the hand	<a href="#">A61H 2205/065</a>
for active exercising	<a href="#">A63B 23/16</a>

**A61H 1/0288****{Fingers}****References****Informative references***Attention is drawn to the following places, which may be of interest for search:*

Interface for the hands	<a href="#">A61H 2201/1635</a>
Therapy devices for the fingers	<a href="#">A61H 2205/067</a>
for active exercising	<a href="#">A63B 23/16</a>

**A61H 1/0292****{for the spinal column ([A61H 1/0218](#) takes precedence)}****References****Informative references***Attention is drawn to the following places, which may be of interest for search:*

Interface for the back	<a href="#">A61H 2201/1623</a>
Therapy devices for the back	<a href="#">A61H 2205/081</a>
for active exercising	<a href="#">A63B 23/0238</a>

**A61H 1/0296****{Neck}****References****Informative references***Attention is drawn to the following places, which may be of interest for search:*

Interface for the neck	<a href="#">A61H 2201/1609</a>
Therapy devices for the neck	<a href="#">A61H 2205/04</a>
for active exercising	<a href="#">A63B 23/025</a>

**A61H 3/00**

Appliances for aiding patients or disabled persons to walk about (apparatus for helping babies to walk [A47D 13/04](#); {orthopaedic devices for correcting deformities of, or supporting, limbs [A61F 5/0102](#)}; exercising apparatus for the feet or toes [A63B 23/10](#); {stairways or ramps [E04F 11/00](#)})

**Definition statement***This place covers:*

Crutches, walkers, suspension devices or exoskeletons specifically made for aiding a disabled person to walk around, not on a treadmill.

**References****Limiting references***This place does not cover:*

Walking coordination of arms and legs	<a href="#">A61H 2001/0211</a>
Simulation of the walking movement, or part of it, of the legs	<a href="#">A61H 1/0262</a>
Active exercise on a treadmill	<a href="#">A63B 22/02</a>
Exoskeletons for increasing strength (not specifically for supporting disabled persons)	<a href="#">B25J 9/0006</a>
Control system for manipulators, e.g. exoskeletons	<a href="#">B25J 9/16</a>

**Informative references***Attention is drawn to the following places, which may be of interest for search:*

Control means	<a href="#">A61H 2201/50</a>
Walking sticks and Nordic walking sticks	<a href="#">A45B 1/00</a> - <a href="#">A45B 7/00</a>
Apparatus for helping babies to walk	<a href="#">A47D 13/04</a>
Orthopaedic devices for correcting deformities of, or supporting limbs	<a href="#">A61F 5/0102</a>
Standing-up or sitting-down aids	<a href="#">A61G 5/14</a>
Applying electrical currents by contact electrodes for stimulating motor muscles, e.g. walking assistance	<a href="#">A61N 1/36003</a>
Active exercise apparatus for the feet	<a href="#">A63B 23/04</a>



Exercising apparatus for the feet or toes	<a href="#">A63B 23/10</a>
Training for running, jogging or speed walking	<a href="#">A63B 69/0028</a>
Vehicles with legs	<b>B62D57/03</b>
Stairways or ramps	<a href="#">E04F 11/00</a>

### Special rules of classification

Exoskeletons specifically made for aiding disabled persons to walk are classified here in [A61H 3/00](#). If the exoskeleton is bending a joint (i.e. not only for supporting the weight), the joint which is moved has to be classified in [A61H 1/0237](#), the exoskeletons are normally portable [A61H 2201/0157](#) and wearable [A61H 2201/165](#), whereby wearable takes precedence over portable and therefore portable does not have to be coded.

Use orthogonal classification for additional information as well as for invention information ([A61H 2003/001](#) - [A61H 2003/007](#)).

For further additional information the orthogonal classification ([A61H 2201/00](#), [A61H 2230/85](#)) is used.

## A61H 2003/001

{on steps or stairways}

### References

#### Informative references

Attention is drawn to the following places, which may be of interest for search:

Lift associated with stairs	<a href="#">B66B 9/08</a>
Built-in aids for ascending or descending stairs	<a href="#">E04F 11/1863</a>

## A61H 2003/002

{with attached or incorporated article carrying means}

### References

#### Informative references

Attention is drawn to the following places, which may be of interest for search:

For walking sticks	<a href="#">A45B 1/00</a>
Sticks or Umbrellas with coat-hangers	<a href="#">A45B 3/06</a>
Holders or carriers for hand articles	<a href="#">A45F 5/00</a>

**A61H 2003/003****{Umbrellas}****References****Informative references***Attention is drawn to the following places, which may be of interest for search:*

Umbrellas	<a href="#">A45B 11/00</a>
Holder for umbrellas	<a href="#">B60R 7/12</a>

**A61H 2003/004****{Trays}****References****Informative references***Attention is drawn to the following places, which may be of interest for search:*

Sticks or umbrellas with containers for storing objects	<a href="#">A45B 2200/1054</a>
Sticks or umbrellas with tables	<a href="#">A45B 2200/1063</a>

**A61H 2003/005****{with knee, leg or stump rests}****References****Informative references***Attention is drawn to the following places, which may be of interest for search:*

Interface for lower limbs	<a href="#">A61H 2201/164</a>
Walking sticks or umbrellas convertible into seats	<a href="#">A45B 5/00</a>

**A61H 2003/006****{with forearm rests, i.e. for non-used arms}****References****Informative references***Attention is drawn to the following places, which may be of interest for search:*

Interface for arms	<a href="#">A61H 2201/1635</a>
--------------------	--------------------------------

**A61H 2003/007****{secured to the patient, e.g. with belts}****References****Informative references***Attention is drawn to the following places, which may be of interest for search:*

Physical interface with patient	<a href="#">A61H 2201/16</a>
Wearable	<a href="#">A61H 2201/165</a>

**A61H 3/008****{Using suspension devices for supporting the body in an upright walking or standing position, e.g. harnesses (drawing-out devices [A61H 1/0218](#))}****Definition statement***This place covers:*

Devices suspending a disabled person walking or standing

**References****Limiting references***This place does not cover:*

For small children	<a href="#">A47D 13/04</a>
--------------------	----------------------------

**Informative references***Attention is drawn to the following places, which may be of interest for search:*

Thorax holding means	<a href="#">A61H 2201/1621</a>
Body harness	<a href="#">A62B 5/00</a>

**A61H 3/02****Crutches****References****Informative references***Attention is drawn to the following places, which may be of interest for search:*

Walking sticks	<a href="#">A45B 1/00</a>
Telescoping connections	<a href="#">F16B 7/10</a>

## A61H 2003/0205

{Crutches with no pivoting movement during use, e.g. tripods}

### Definition statement

*This place covers:*



## A61H 2003/0211

{with curved ground-engaging means, i.e. rockers}

### Definition statement

*This place covers:*

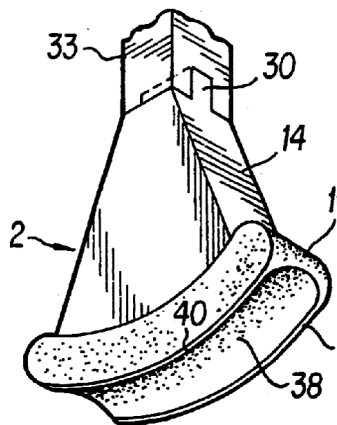

A61H 2003/0216

{Crutches in which movement is limited to a pivoting in one plane, e.g. 2-point supports}

Definition statement

This place covers:

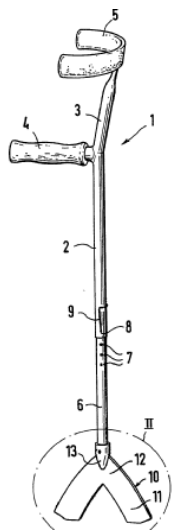

A61H 2003/0222

{with means for grasping or picking-up objects}

References

Informative references

Attention is drawn to the following places, which may be of interest for search:

Collecting crops spread on the soil	<a href="#">A01D 51/00</a>
Devices for picking-up balls	<a href="#">A63B 47/00</a>

A61H 2003/0227

{convertible from armpit- into forearm-model}

References

Informative references

Attention is drawn to the following places, which may be of interest for search:

Interface for the upper limbs	<a href="#">A61H 2201/1635</a>
-------------------------------	--------------------------------

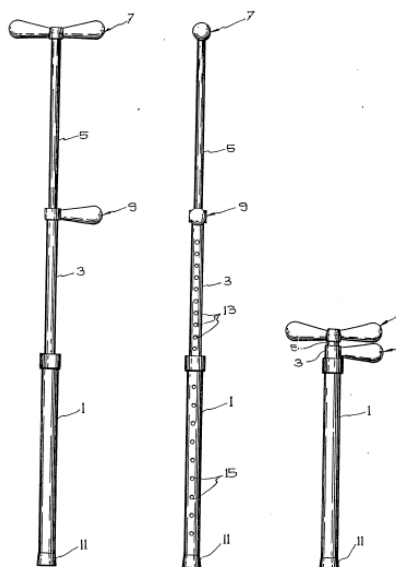
**A61H 2003/0233****{convertible from armpit crutch into cane}****Definition statement***This place covers:*

EP0236708

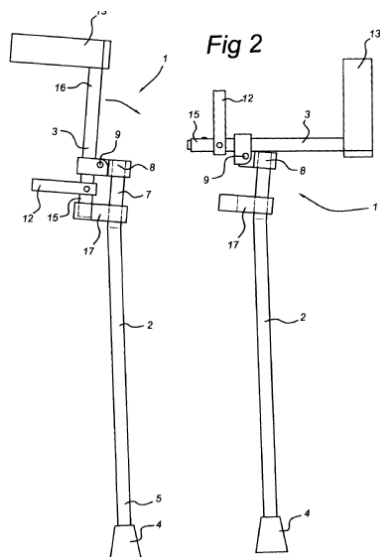
**A61H 2003/0238****{convertible from forearm crutch into cane}****Definition statement***This place covers:*

NL2000270C

**A61H 3/0244****{Arrangements for storing or keeping upright when not in use}****References****Informative references***Attention is drawn to the following places, which may be of interest for search:*

Walking sticks with hanging means	<a href="#">A45B 1/04</a>
Cane or umbrella stands or holders	<a href="#">A47G 25/12</a>

**A61H 2003/025****{with devices for securing a pair of crutches together}****References****Informative references***Attention is drawn to the following places, which may be of interest for search:*

Devices for binding skis in pairs	<a href="#">A63C 11/021</a>
-----------------------------------	-----------------------------

**A61H 2003/0255****{on a single crutch for being fixed on or supported by a wall, furniture or the like}****References****Informative references***Attention is drawn to the following places, which may be of interest for search:*

Devices for fastening to tables, walls or the like	<a href="#">A47G 29/087</a>
--	-----------------------------

**A61H 2003/0261****{on walls or furniture for receiving single crutches}****References****Informative references***Attention is drawn to the following places, which may be of interest for search:*

Devices for fastening to tables, walls or the like	<a href="#">A47G 29/087</a>
--	-----------------------------

**A61H 2003/0266**

{with magnetic fixing}

**References****Informative references***Attention is drawn to the following places, which may be of interest for search:*

Devices for binding skis in pairs with magnets	<a href="#">A63C 11/022</a>
--	-----------------------------

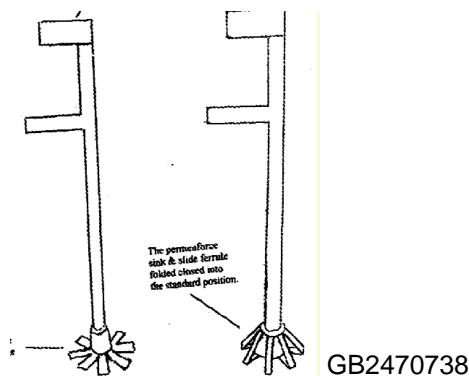
**A61H 2003/0272**{on a single crutch allowing it to remain upright when not in use, e.g. retractable tripods ([A61H 2003/0205](#) takes precedence)}**Definition statement***This place covers:***A61H 3/0277**

{Shock absorbers therefor}

**References****Informative references***Attention is drawn to the following places, which may be of interest for search:*

shock absorbers for active exercising	<a href="#">A63B 2071/0063</a>
---------------------------------------	--------------------------------

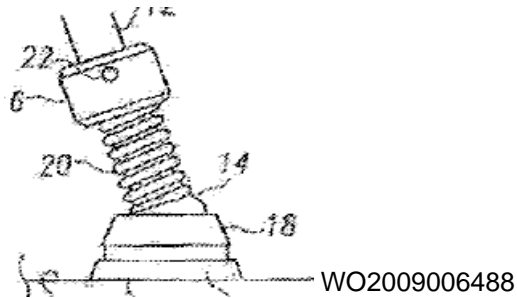

**A61H 2003/0283****{using elastomeric material}****Definition statement***This place covers:***A61H 3/0288****{Ferrules or tips therefor (for walking sticks or umbrellas [A45B 9/04](#))}****References****Informative references***Attention is drawn to the following places, which may be of interest for search:*

Ferrules or tips for walking sticks	<a href="#">A45B 9/04</a>
-------------------------------------	---------------------------

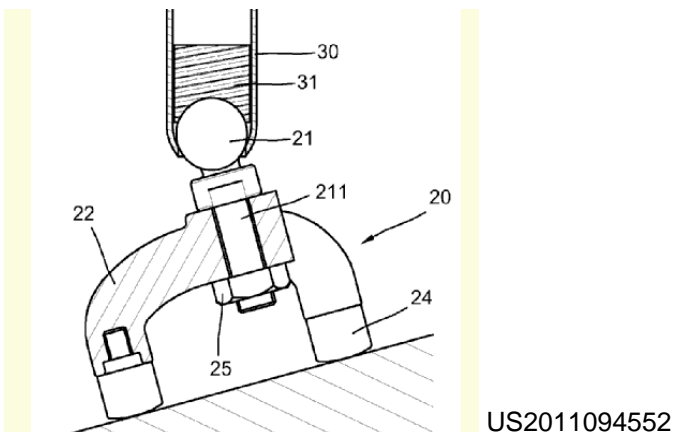
**A61H 2003/0294****{comprising a ball-and-socket joint}****Definition statement***This place covers:*

## A61H 3/04

Wheeled walking aids for disabled persons {(A61H 3/06 takes precedence)}

### Definition statement

*This place covers:*



### References

#### Limiting references

*This place does not cover:*

Walking aid using suspension devices for supporting	<a href="#">A61H 3/008</a>
Walking aids for blind persons	<a href="#">A61H 3/06</a>
Wheelchairs	<a href="#">A61G 5/00</a>

#### Informative references

*Attention is drawn to the following places, which may be of interest for search:*

Hand carts	<a href="#">B62B 1/00</a>
------------	---------------------------

## A61H 2003/043

{with a drive mechanism}

### Definition statement

*This place covers:*

also driven by human, by means of a driving mechanism, not by pushing it through handles

### References

#### Informative references

*Attention is drawn to the following places, which may be of interest for search:*

Driving means for hand carts	<a href="#">B62B 5/0026</a>
------------------------------	-----------------------------

**A61H 2003/046****{with braking means}****References****Informative references***Attention is drawn to the following places, which may be of interest for search:*

Braking means for hand carts	<a href="#">B62B 5/04</a>
------------------------------	---------------------------

**A61H 3/06****Walking aids for blind persons (replacing direct visual perception by another kind of perception [A61F 9/08](#))****References****Limiting references***This place does not cover:*

Replacing direct visual perception by another kind of perception	<a href="#">A61F 9/08</a>
--	---------------------------

**Informative references***Attention is drawn to the following places, which may be of interest for search:*

Walking sticks in general	<a href="#">A45B</a>
Walking sticks	<a href="#">A45B 1/00</a>

**A61H 3/061****{with electronic detecting or guiding means}****References****Informative references***Attention is drawn to the following places, which may be of interest for search:*

Replacing direct visual perception by another kind of perception	<a href="#">A61F 9/08</a>
Systems using wave reflection for anti-collision	<a href="#">G01S 17/93</a>
Guiding mean along a path, e.g. evacuation path	<a href="#">G08B 7/066</a>
Teaching or communicating with blinds	<a href="#">G09B 21/001</a>
Portable phone for visually impaired user	<a href="#">H04M 1/72481</a>

**A61H 2003/063****{with tactile perception}****References****Informative references***Attention is drawn to the following places, which may be of interest for search:*

Device or method change consciousness by the tactile sense	<a href="#">A61M 2021/0022</a>
Means for aiding people with impaired vision by tactile feedback	<a href="#">A61M 2205/582</a>
Non-audiovisual navigation guidance, e.g. tactile, haptic, or electric stimuli	<a href="#">G01C 21/3652</a>
Communicating with blinds using tactile presentation of information	<a href="#">G09B 21/003</a>

**A61H 2003/065****{in the form of braille}****References****Informative references***Attention is drawn to the following places, which may be of interest for search:*

Typewriters or selective printing for printing in Braille	<a href="#">B41J 3/00</a>
Printing processes for printing Braille	<a href="#">B41M 3/16</a>

**A61H 3/066****{Installations on the floor, e.g. special surfaces, to guide blind persons}****References****Informative references***Attention is drawn to the following places, which may be of interest for search:*

Physical characteristic of the surface	<a href="#">A61H 2201/169</a>
Construction of surfaces for roads, sport grounds or the like	<a href="#">E01C 1/00</a>
Road signs or traffic signals	<a href="#">E01F 9/50</a>

**A61H 3/068****{Sticks for blind persons}****References****Informative references***Attention is drawn to the following places, which may be of interest for search:*

For walking sticks	<a href="#">A45B 1/00</a>
Systems using wave reflection for anti-collision	<a href="#">G01S 17/93</a>

Communicating with blind persons by means of audio signals	<a href="#">G09B 21/006</a>
--	-----------------------------

## A61H 5/00

### Exercisers for the eyes

#### Definition statement

*This place covers:*

Apparatus or processes, which are not used for surgical purposes that are specially adapted to improve or promote the optical functioning of individuals (e.g. rectify defective vision, improve the natural operation of their eyes)

#### References

##### Informative references

*Attention is drawn to the following places, which may be of interest for search:*

Apparatus for testing the eyes	<a href="#">A61B 3/00</a>
Apparatus for determining the visual field	<a href="#">A61B 3/024</a>

#### Special rules of classification

For further additional information the orthogonal classification ([A61H 2201/00](#), [A61H 2230/85](#)) is used.

## A61H 5/005

### {Exercisers for training the stereoscopic view}

#### References

##### Limiting references

*This place does not cover:*

Stereoscopic television system	<a href="#">H04N 13/00</a>
--------------------------------	----------------------------

## A61H 7/00

**Devices for suction-kneading massage; Devices for massaging the skin by rubbing or brushing not otherwise provided for (electro-medical massage devices applying electric current by contact [A61N 1/18](#))**

#### Definition statement

*This place covers:*

Apparatus or processes which are not used for surgical purposes utilizing mechanical energy directly applied upon human bodies by physical contact (e.g. massage) to rub, or knead, a portion of the external surface of human bodies, or the surfaces of their naturally occurring body cavities

## References

### Limiting references

*This place does not cover:*

Electro-medical massage devices applying electric current by contact	<a href="#">A61N 1/18</a>
--	---------------------------

### Informative references

*Attention is drawn to the following places, which may be of interest for search:*

Massage by means of rollers and balls	<a href="#">A61H 15/00</a>
Layer between the skin and massage elements	<a href="#">A61H 2201/1654</a>
Footwear with protrusions for acupressure	<a href="#">A43B 3/108</a> , <a href="#">A43B 3/128</a>
Brushes in general	<a href="#">A46B</a>
Bathing sponges, brushes, gloves or similar cleaning or rubbing implements not specially for massage	<a href="#">A47K 7/02</a>
Suction device for nursing	<a href="#">A61M 1/06</a> , <a href="#">A61M 1/08</a>

## Special rules of classification

For additional information the orthogonal classification ([A61H 2201/00](#), [A61H 2230/85](#)) is used.

## A61H 7/001

{without substantial movement between the skin and the device}

## References

### Limiting references

*This place does not cover:*

Pressing acupuncture points	<a href="#">A61H 39/04</a>
-----------------------------	----------------------------

## A61H 7/002

{by rubbing or brushing}

## References

### Informative references

*Attention is drawn to the following places, which may be of interest for search:*

Brushes in general	<a href="#">A46B 1/00</a>
--------------------	---------------------------

**A61H 7/003****{Hand-held or hand-driven devices}****References****Limiting references***This place does not cover:*

Brushes	<a href="#">A46B 13/08</a>
---------	----------------------------

**Informative references***Attention is drawn to the following places, which may be of interest for search:*

Driven by a human being	<a href="#">A61H 2201/1253</a>
-------------------------	--------------------------------

**A61H 7/004****{power-driven, e.g. electrical}****Definition statement***This place covers:*

Massage means is power-driven, whole device or only interface

**References****Limiting references***This place does not cover:*

Power-driven brushes	<a href="#">A46B 13/02</a>
Power-driven toothbrushes	<a href="#">A61C 17/16</a>

**Informative references***Attention is drawn to the following places, which may be of interest for search:*

Vibrating driving means	<a href="#">A61H 23/00</a>
Artificial respiration or heart stimulation power-driven	<a href="#">A61H 31/006</a>
with electric or magnetic drive	<a href="#">A61H 2201/1207</a>
with hydraulic or pneumatic drive	<a href="#">A61H 2201/1238</a>

**A61H 7/005****{hand-held}****References****Informative references***Attention is drawn to the following places, which may be of interest for search:*

Hand-held nozzles	<a href="#">A61H 33/6036</a>
-------------------	------------------------------

Handheld	<a href="#">A61H 2201/0153</a>
----------	--------------------------------

## A61H 7/006

{Helmets for head-massage (baths for the head [A61H 35/008](#); washing, rinsing, drying [A45D](#))}

### References

#### Limiting references

*This place does not cover:*

Baths for the head	<a href="#">A61H 35/008</a>
Washing, rinsing, drying	<a href="#">A45D 1/00</a>
Hair care preparations for care of hair	<a href="#">A61Q 5/00</a>

## A61H 7/007

{Kneading}

### Definition statement

*This place covers:*

Kneading is a circular technique by which the skin and its underlying structure are moved in a circular rotating motion on the underlying structures (e.g. of muscles, tendons, ligaments, bones). Tissue is lifted and rolled away from the bone, and then back towards the bone with a squeezing compressive action

## A61H 7/008

{Suction kneading}

### Definition statement

*This place covers:*

Kneading massage in which the lifting of the tissue is obtained by vacuum

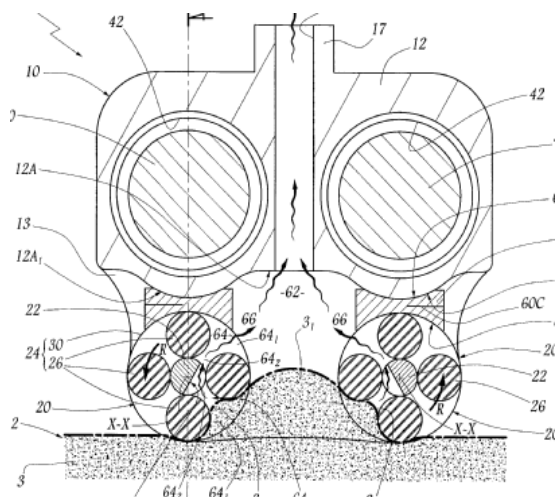

WO2007147964



**A61H 2007/009****{having massage elements rotating on parallel output axis}****Definition statement***This place covers:*

Kneading massage in which the lifting of the tissue is obtained by rotation of elements mounted on parallel axis . The axis can be parallel or perpendicular to the skin.

Parallel

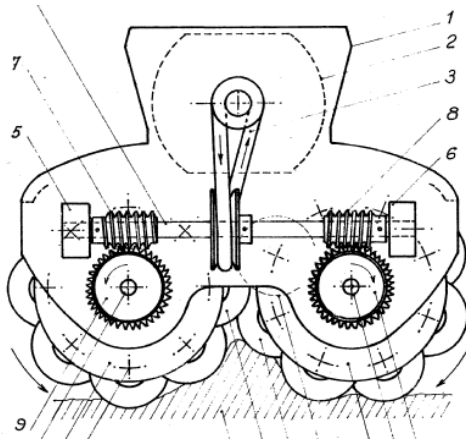

FR2347035

Perpendicular

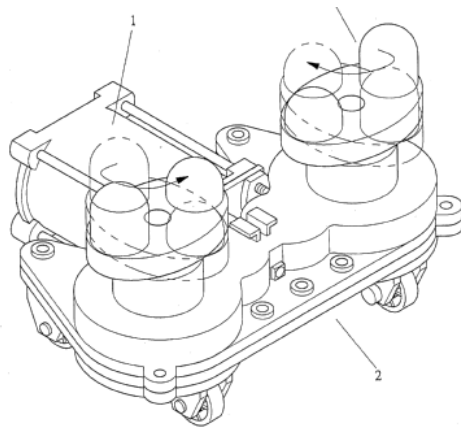

FR2854566

**A61H 9/00****Pneumatic or hydraulic massage****Definition statement***This place covers:*

Pneumatic or hydraulic massage means acting either directly on the skin or on a layer positioned between the skin and the massage means, e.g. sprays

## References

### Informative references

Attention is drawn to the following places, which may be of interest for search:

Gum massage	<a href="#">A61H 13/00</a>
Underwater massage, spraying system acting on a body or body part immersed in water	<a href="#">A61H 33/00</a> , <a href="#">A61H 35/00</a>
Hydraulic or pneumatic drive	<a href="#">A61H 2201/1238</a>
Hydraulic or pneumatic transmission means	<a href="#">A61H 2201/1409</a>
Layer between the skin and massage elements	<a href="#">A61H 2201/1654</a>
Brushes with fluid supply	<a href="#">A46B 11/00</a>
Nozzles per se	<a href="#">B05B</a>

## Special rules of classification

For additional information the orthogonal classification ([A61H 2201/00](#), [A61H 2230/85](#)) is used.

## A61H 9/0007

{Pulsating}

## References

### Informative references

Attention is drawn to the following places, which may be of interest for search:

Percussion massage	<a href="#">A61H 23/006</a>
Nozzles for pulsating streams in bathing devices	<a href="#">A61H 33/6057</a>

## A61H 2009/0014

{with particles, e.g. sand}

## Definition statement

*This place covers:*

Fluids loaded with particles

A61H 9/0021

{Hydraulic massage}

Definition statement

This place covers:  
Liquid jets for localized massage on a body not immersed in water.

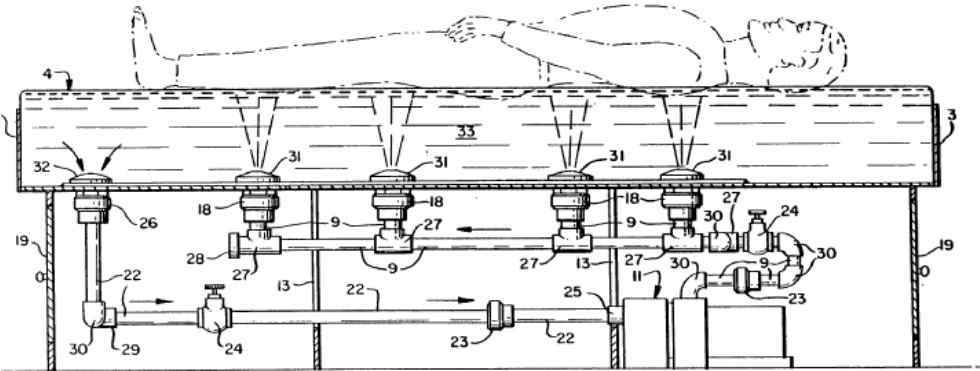

WO8804918

References

Informative references

Attention is drawn to the following places, which may be of interest for search:

Massaging with hydrostatic pressure	<a href="#">A61H 2023/045</a>
Heated or cooled	<a href="#">A61H 2201/02</a>
Having a layer between the skin and the fluid	<a href="#">A61H 2201/1654</a>
Surface of interface being disposable	<a href="#">A61H 2201/1688</a>
Control means	<a href="#">A61H 2201/50</a>
Specific part of the body to be treated	<a href="#">A61H 2205/00</a>

A61H 9/0028

{Hand-held devices for spraying and removing liquid while moved on the skin}

References

Informative references

Attention is drawn to the following places, which may be of interest for search:

Dental suction-irrigation	<a href="#">A61C 17/0208</a>
Medical suction-irrigation	<a href="#">A61M 1/71</a> , <a href="#">A61M 1/77</a>

A61H 2009/0035

{with cabin for the whole body}

Definition statement

This place covers:

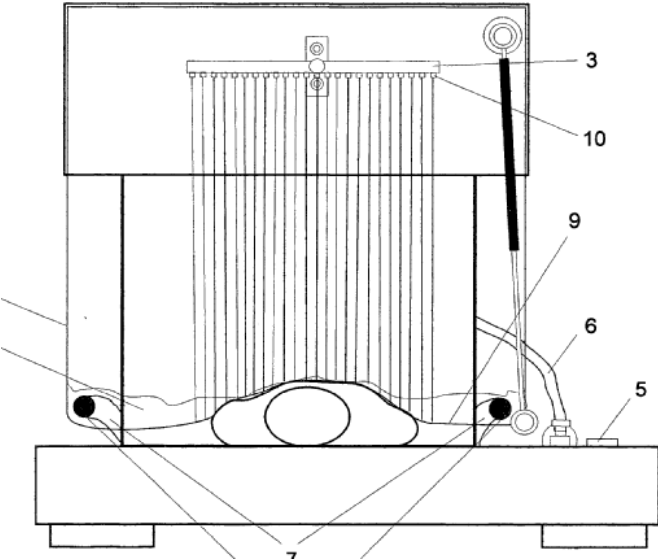

DE202008009644U

A61H 2009/0042

{with water recirculation}

References

Informative references

Attention is drawn to the following places, which may be of interest for search:

Hand-held devices for spraying and removing liquid while moved on the skin	<a href="#">A61H 9/0028</a>
--	-----------------------------

A61H 9/005

{Pneumatic massage}

References

Informative references

Attention is drawn to the following places, which may be of interest for search:

Iron lungs	<a href="#">A61H 31/02</a>
Cupping glasses e.g. for removing venom by suction	<a href="#">A61M 1/08</a>

**A61H 9/0057****{Suction (suction kneading [A61H 7/008](#))}****References****Limiting references***This place does not cover:*

suction kneading massage	<a href="#">A61H 7/008</a>
--------------------------	----------------------------

**A61H 2009/0064****{suction by releasing a flexible cup after deformation, i.e. without further vacuum source}****References****Informative references***Attention is drawn to the following places, which may be of interest for search:*

Portable	<a href="#">A61H 2201/0157</a>
----------	--------------------------------

**A61H 9/0071****{by localized pressure, e.g. air streams or jets}****Definition statement***This place covers:*

Air streams or jets for localized massages

**References****Informative references***Attention is drawn to the following places, which may be of interest for search:*

Using fluids loaded with particles	<a href="#">A61H 2009/0014</a>
------------------------------------	--------------------------------

**A61H 9/0078****{with intermittent or alternately inflated bladders or cuffs (mattresses for preventing bed-sores with alternated pressurized chambers [A61G 7/05776](#))}****References****Limiting references***This place does not cover:*

mattresses for preventing bed-sores with alternated pressurised chambers	<a href="#">A61G 7/05776</a>
--	------------------------------

**Informative references**

Attention is drawn to the following places, which may be of interest for search:

Heated or cooled	<a href="#">A61H 2201/02</a>
Control means	<a href="#">A61H 2201/50</a>
Specific part of the body to be treated	<a href="#">A61H 2205/00</a>
Controlled by heartbeat rate	<a href="#">A61H 2230/065</a>

**A61H 9/0085**

{Inflated by user's body movement, e.g. ambulatory devices}

**References****Informative references**

Attention is drawn to the following places, which may be of interest for search:

Driven by human being	<a href="#">A61H 2201/1253</a>
-----------------------	--------------------------------

**A61H 9/0092**

{Cuffs therefor}

**References****Informative references**

Attention is drawn to the following places, which may be of interest for search:

Having a layer between the skin and the fluid	<a href="#">A61H 2201/1654</a>
Surface of interface being disposable	<a href="#">A61H 2201/1688</a>
Shoes with internal pneumatic chambers	<a href="#">A43B 13/20</a> , <a href="#">A43B 17/03</a>

**A61H 11/00**

**Belts, strips or combs for massage purposes**

**Definition statement**

*This place covers:*

Apparatus or processes which are not used for surgical purposes utilizing mechanical energy directly applied upon human bodies by physical contact (e.g. massage) through belts or strips to massage a portion of the external surface of human bodies, or the surfaces of their naturally occurring body cavities

**Special rules of classification**

For additional information the orthogonal classification ([A61H 2201/00](#), [A61H 2230/85](#)) is used.

**A61H 2011/005**

{with belt or strap expanding and contracting around an encircled body part}

**References****Informative references**

Attention is drawn to the following places, which may be of interest for search:

Artificial respiration or heart stimulation (CPR)	<a href="#">A61H 31/00</a>
---	----------------------------

**A61H 11/02**

**Massage devices with strips oscillating lengthwise**

**Definition statement**

*This place covers:*

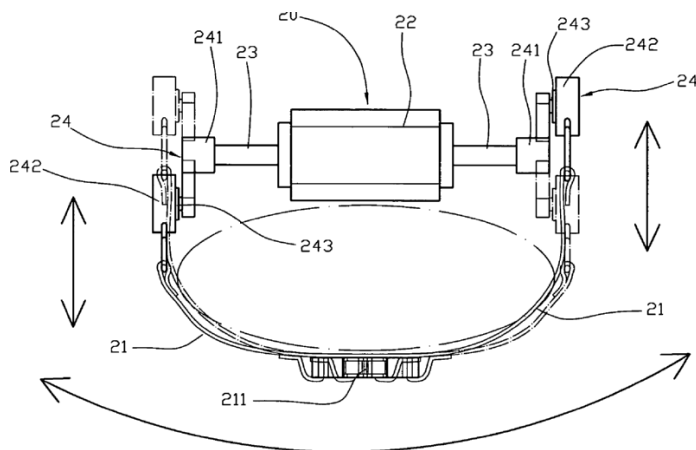
**A61H 13/00**

**Gum massage**

**Special rules of classification**

For additional information the orthogonal classification ([A61H 2201/00](#), [A61H 2230/85](#)) is used.

**A61H 13/005**

{Hydraulic gum massage}

**References****Informative references**

Attention is drawn to the following places, which may be of interest for search:

Instruments or machines for rinsing the teeth	<a href="#">A61C 17/02</a>
---	----------------------------

A61H 15/00

Massage by means of rollers, balls, e.g. inflatable, chains, or roller chains

Definition statement

*This place covers:*

The massage means acting either directly on the skin or on a layer positioned between the skin and the massage means

Roller chains are connected flexible series of links fastening a series of rollers for massaging purposes.

CN200973812Y

References

Informative references

Attention is drawn to the following places, which may be of interest for search:

Power driven	<a href="#">A61H 15/0078</a>
Handheld, driven by human being	<a href="#">A61H 15/0092</a>
Portable	<a href="#">A61H 2201/0157</a>
Specific driving means	<a href="#">A61H 2201/12</a>
Layer between the skin and massage elements	<a href="#">A61H 2201/1654</a>
Specific part of the body to be treated	<a href="#">A61H 2205/00</a>

Special rules of classification

Types of rollers should be classified in the orthogonal classification [A61H 2015/0071](#).

For additional information the orthogonal classification ([A61H 2201/00](#), [A61H 2230/85](#)) is used.

A61H 2015/0007

{with balls or rollers rotating about their own axis}

Definition statement

*This place covers:*

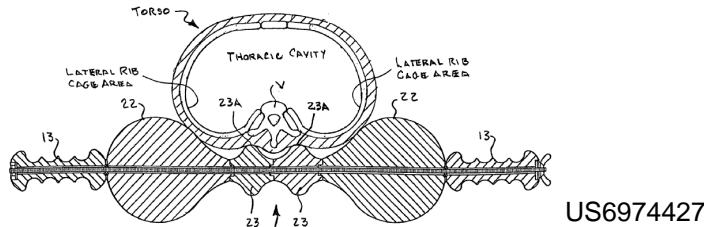

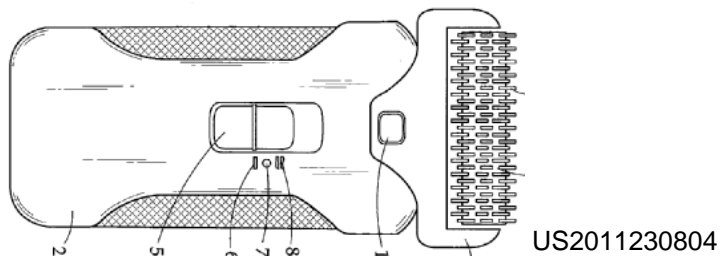
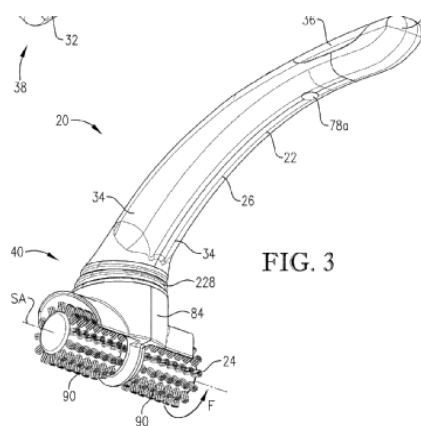

**A61H 2015/0014****{cylinder-like, i.e. rollers}****Definition statement***This place covers:***A61H 2015/0021****{multiple on the same axis}****Definition statement***This place covers:*

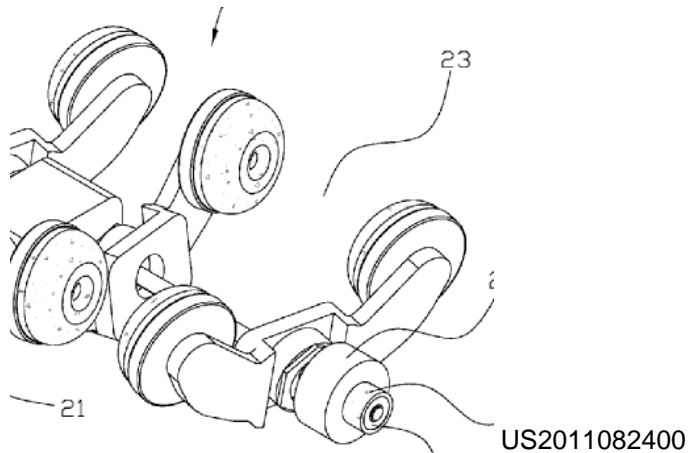
**A61H 2015/0028****{disc-like, i.e. diameter substantially greater than width}****Definition statement***This place covers:*

US2011082400

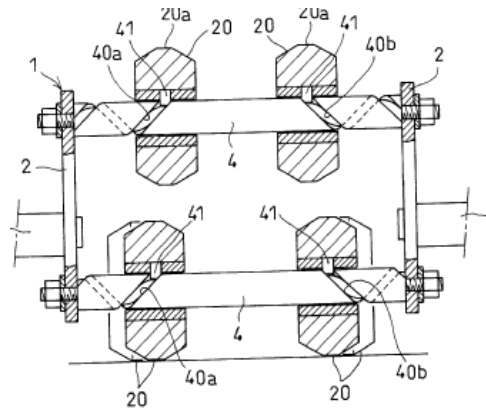
**A61H 2015/0035****{multiple on the same axis}****Definition statement***This place covers:*

WO2011027426

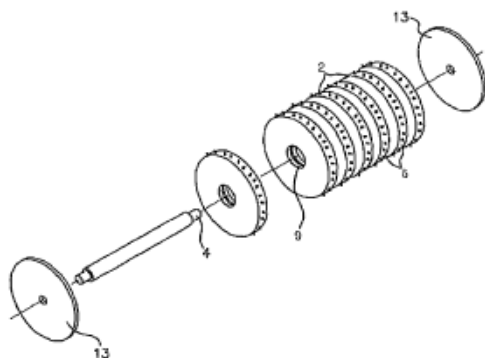

EP2347789

## A61H 2015/0042

{Balls or spheres}

### Definition statement

*This place covers:*

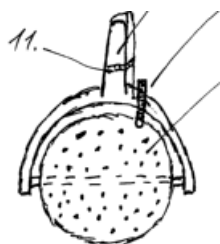

DE202008005686U

## A61H 2015/005

{multiple on the same axis}

### Definition statement

*This place covers:*

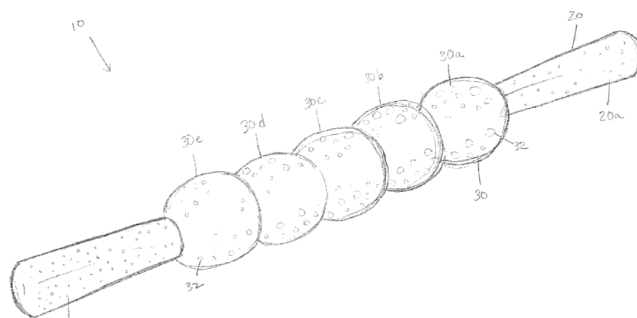

US2011313333

## A61H 2015/0057

{the axis being resiliently biased}

### Definition statement

*This place covers:*

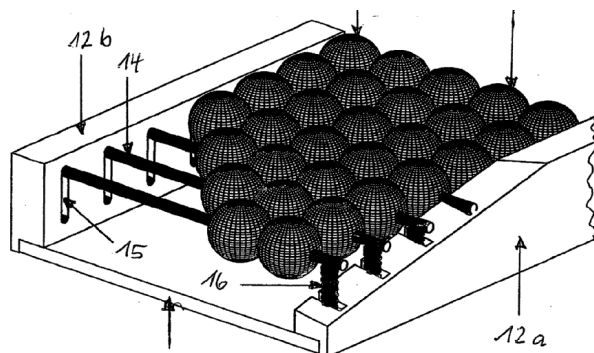

DE202006006704U

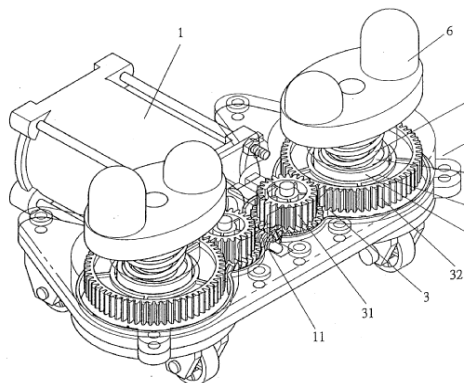

FR2854566

## A61H 2015/0064

{with freely rotating spheres}

### Definition statement

*This place covers:*

Freely rotating spheres like a ball-pen or roll-on on deodorants

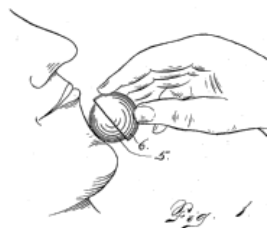

US754925

## A61H 2015/0071

{with balls or rollers having built-in vibrating means}

### References

#### Informative references

Attention is drawn to the following places, which may be of interest for search:

Vibrating means	<a href="#">A61H 23/00</a>
-----------------	----------------------------

## A61H 15/0078

{power-driven}

### Definition statement

*This place covers:*

Massage means is power-driven, whole device or only interface

## References

### Informative references

Attention is drawn to the following places, which may be of interest for search:

Vibration driving means	<a href="#">A61H 23/00</a>
Driving means	<a href="#">A61H 2201/12</a>

## A61H 15/0085

{hand-held}

## References

### Informative references

Attention is drawn to the following places, which may be of interest for search:

Hand-held nozzles	<a href="#">A61H 33/6036</a>
Hand-held for other kind of devices in <a href="#">A61H</a>	<a href="#">A61H 2201/0153</a>

## A61H 15/0092

{hand-held ([A61H 15/0085](#) takes precedence)}

## References

### Informative references

Attention is drawn to the following places, which may be of interest for search:

Hand-held nozzles	<a href="#">A61H 33/6036</a>
Hand-held for other kind of devices in <a href="#">A61H</a>	<a href="#">A61H 2201/0153</a>

## A61H 15/02

adapted for simultaneous treatment with light, heat or drugs

## References

### Informative references

Attention is drawn to the following places, which may be of interest for search:

Heated or cooled	<a href="#">A61H 2201/02</a>
Further special therapeutic means	<a href="#">A61H 2201/10</a>
Appliances specially adapted for applying liquid, e.g. using roller or ball	<a href="#">A45D 34/04</a>
Heating cooling appliances for medical or therapeutic use	<a href="#">A61F 7/00</a>
Aromatherapy	<a href="#">A61M 2021/0016</a>
Electrotherapy	<a href="#">A61N 1/00</a>
Magnetotherapy	<a href="#">A61N 2/00</a>
Radiation therapy	<a href="#">A61N 5/00</a>
Radiation by LEDs	<a href="#">A61N 2005/0651</a>

Infrared	<a href="#">A61N 2005/0659</a>
Ultraviolet	<a href="#">A61N 2005/0661</a>
Chromotherapy	<a href="#">A61N 2005/0663</a>

## A61H 19/00

**Massage for the genitals; {Devices for improving sexual intercourse (penis erection devices [A61F 5/41](#); vibration or percussion related aspects [A61H 23/00](#))}**

### Definition statement

*This place covers:*

Massage devices used for increasing the experience during sexual intercourse

### References

#### Limiting references

*This place does not cover:*

Artificial penis erection devices	<a href="#">A61F 5/41</a>
-----------------------------------	---------------------------

#### Informative references

*Attention is drawn to the following places, which may be of interest for search:*

Vibration means	<a href="#">A61H 23/00</a>
Incorporated in furniture	<a href="#">A61H 2201/0138</a>
Portable	<a href="#">A61H 2201/0157</a>
Heated or cooled	<a href="#">A61H 2201/02</a>
Driving means	<a href="#">A61H 2201/12</a>
Disposable	<a href="#">A61H 2201/1688</a>
Control means	<a href="#">A61H 2201/50</a>
Taking sperma sample	<a href="#">A61B 10/0058</a>
Condoms	<a href="#">A61F 6/04</a>

### Special rules of classification

For additional information the orthogonal classification ([A61H 2201/00](#), [A61H 2230/85](#)) is used.

## A61H 19/30

**{Devices for external stimulation of the genitals}**

### References

#### Informative references

*Attention is drawn to the following places, which may be of interest for search:*

Surface with enhanced rubbing effect	<a href="#">A61H 2201/1692</a>
--------------------------------------	--------------------------------

**A61H 19/32**

{for inserting the genitals therein, e.g. vibrating rings for males or breast stimulating devices}

**References****Informative references**

Attention is drawn to the following places, which may be of interest for search:

Wearable	<a href="#">A61H 2201/165</a>
----------	-------------------------------

**A61H 19/34**

{For clitoral stimulation}

**References****Informative references**

Attention is drawn to the following places, which may be of interest for search:

Surface with enhanced rubbing effect	<a href="#">A61H 2201/1692</a>
--------------------------------------	--------------------------------

**A61H 19/40**

{Devices insertable in the genitals}

**References****Informative references**

Attention is drawn to the following places, which may be of interest for search:

Watertight	<a href="#">A61H 2201/0111</a>
------------	--------------------------------

**A61H 19/44**

{Having substantially cylindrical shape, e.g. dildos}

**References****Informative references**

Attention is drawn to the following places, which may be of interest for search:

Interchangeable	<a href="#">A61H 2201/1685</a>
-----------------	--------------------------------

**A61H 19/50**

{Devices for use during sexual intercourse}

**Definition statement**

This place covers:

Massage devices used between more persons during sexual intercourse

## References

### Informative references

Attention is drawn to the following places, which may be of interest for search:

Seating furniture for sexual intercourse	<a href="#">A47C 15/008</a>
--	-----------------------------

## A61H 21/00

Massage devices for cavities of the body {, e.g. nose, ears and anus (for the genitals [A61H 19/00](#)); Vibration or percussion related aspects [A61H 23/00](#)}

### Definition statement

*This place covers:*

Massage devices for nose, ears and anus

## References

### Limiting references

*This place does not cover:*

Massage of the genitals	<a href="#">A61H 19/00</a>
-------------------------	----------------------------

### Informative references

Attention is drawn to the following places, which may be of interest for search:

Vibration means	<a href="#">A61H 23/00</a>
-----------------	----------------------------

### Special rules of classification

For additional information the orthogonal classification ([A61H 2201/00](#), [A61H 2230/85](#)) is used.

## A61H 23/00

Percussion or vibration massage, e.g. using supersonic vibration; Suction-vibration massage; Massage with moving diaphragms {(apparatus for passive exercising [A61H 1/00](#); generating or transmitting mechanical vibrations in general [B06B](#))}

### Definition statement

*This place covers:*

Apparatus or processes which are not used for surgical purposes utilizing mechanical energy directly applied upon human bodies by physical contact (e.g. massage) to tap or vibrate the external surface of human bodies, or the surfaces of their naturally occurring body cavities

## References

### Limiting references

*This place does not cover:*

Ultrasound therapy	<a href="#">A61N 7/00</a>
--------------------	---------------------------



**Informative references**

Attention is drawn to the following places, which may be of interest for search:

Apparatus for passive exercising	<a href="#">A61H 1/00</a>
Generating of transmitting mechanical vibrations in general	<a href="#">B06B</a>

**Special rules of classification**

For additional information the orthogonal classification ([A61H 2201/00](#), [A61H 2230/85](#)) is used.

**A61H 2023/002**

{having a percussion element combined with a passive spacer element for bearing against the skin}

**Definition statement**

This place covers:

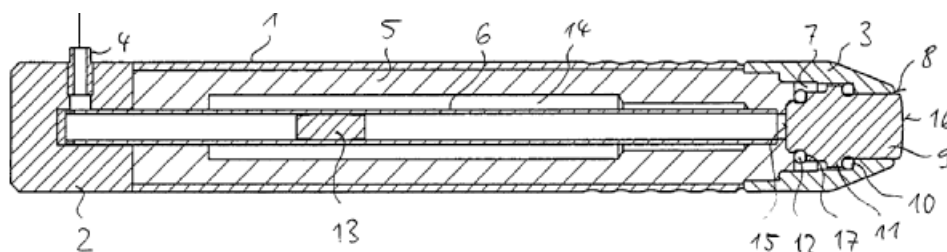

EP2095843

**A61H 23/004**

{With mechanical drive, e.g. spring mechanism or vibrating unit being hit for starting vibration and then applied to the body of a patient}

**Definition statement**

This place covers:

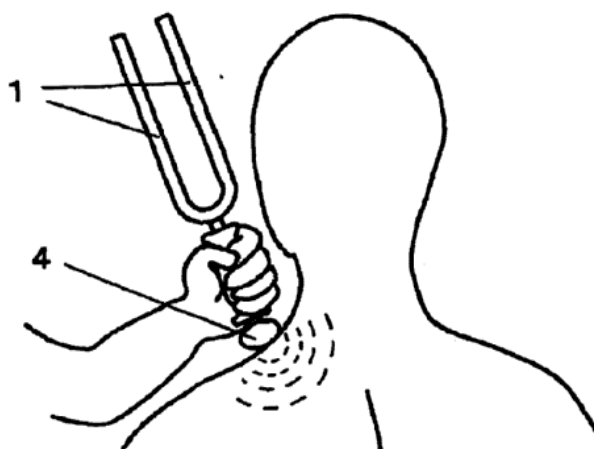

**A61H 23/006****{Percussion or tapping massage (hand percussion [A61H 23/06](#))}****Definition statement***This place covers:*

Alternated pressure on the skin, characterised by higher amplitude, higher force applied and lower frequency respect to a vibration massage. Normally it implies an intermittent contact between the skin and the massaging unit.

**A61H 23/008****{using shock waves}****References****Limiting references***This place does not cover:*

extra-corporal shock wave lithotripsy (ESWL)	<a href="#">A61B 17/225</a>
--	-----------------------------

**A61H 23/02****with electric or magnetic drive****References****Informative references***Attention is drawn to the following places, which may be of interest for search:*

electric or magnetic drive not for percussion or vibration	<a href="#">A61H 2201/1207</a>
--	--------------------------------

**A61H 2023/0209****{powered with frequencies not related to mains frequency}****References****Informative references***Attention is drawn to the following places, which may be of interest for search:*

Frequency controlled AC motor	<a href="#">A61H 2201/1223</a>
-------------------------------	--------------------------------

**A61H 23/0218**

{with alternating magnetic fields producing a translating or oscillating movement}

**References****Informative references**

Attention is drawn to the following places, which may be of interest for search:

Magnetotherapy	<a href="#">A61N 2/00</a>
----------------	---------------------------

**A61H 2023/0227**

{with magnetostrictive elements}

**Definition statement**

*This place covers:*

Magnetostrictive elements can convert magnetic energy into kinetic energy, or the reverse.

**References****Limiting references**

*This place does not cover:*

Piezoelectric transducers	<b>A61H23/P</b>
---------------------------	-----------------

**A61H 23/0236**

{using sonic waves, e.g. using loudspeakers}

**References****Limiting references**

*This place does not cover:*

powered with frequencies not related to mains frequency	<a href="#">A61H 2023/0209</a>
---	--------------------------------

**A61H 23/0245**

{with ultrasonic transducers, e.g. piezoelectric}

**References****Limiting references**

*This place does not cover:*

Magneto-strictive elements	<a href="#">A61H 2023/0227</a>
----------------------------	--------------------------------

A61H 23/0254

{with rotary motor}

Definition statement

This place covers:

Rotating means linked by eccentrics, cams to an interface to set it in vibration

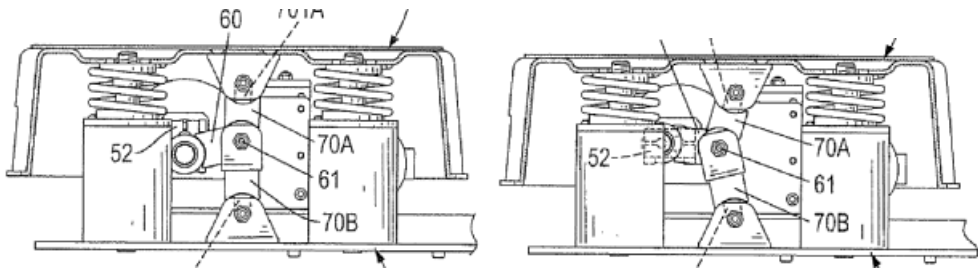

US2009139354

References

Limiting references

This place does not cover:

Rotating unbalanced masses	<a href="#">A61H 23/0263</a>
----------------------------	------------------------------

Informative references

Attention is drawn to the following places, which may be of interest for search:

Electric or magnetic drive not for percussion or vibration	<a href="#">A61H 2201/1207</a>
--	--------------------------------

A61H 23/0263

{using rotating unbalanced masses}

Definition statement

This place covers:

The unbalanced masses causing the driving unit and the parts connected to it to vibrate

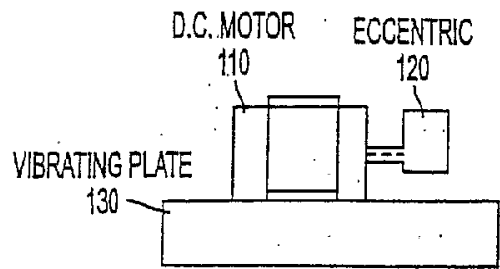

WO2004105868

## References

### Limiting references

*This place does not cover:*

Rotating means linked by eccentrics, cams to an interface to set it in vibration
--

<a href="#">A61H 23/0254</a>
------------------------------

## A61H 2023/0272

{multiple masses each rotated by an individual motor}

### Definition statement

*This place covers:*

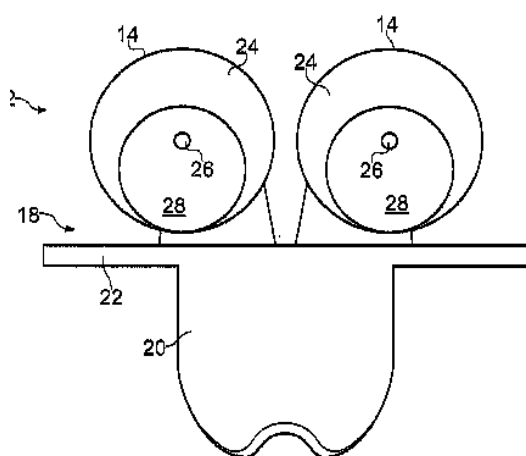

WO2007096594

## A61H 2023/0281

{multiple masses driven by the same motor}

### Definition statement

*This place covers:*

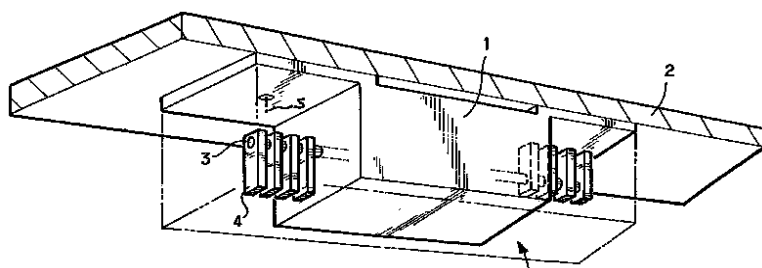

FR2655539

A61H 2023/029

{with variable angular positioning}

Definition statement

This place covers:

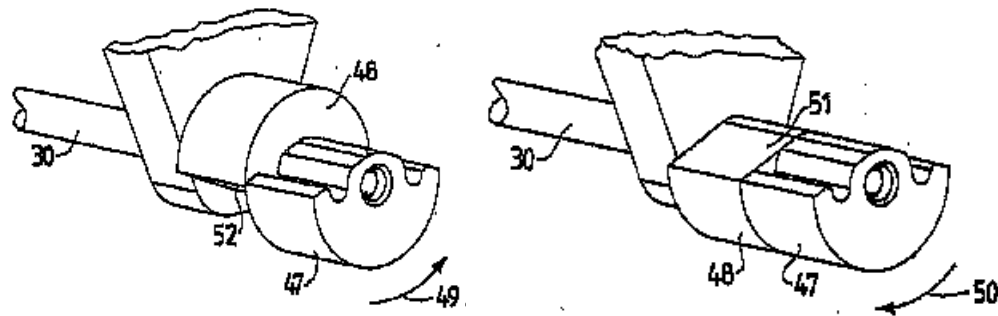

WO03096860

A61H 23/04

with hydraulic or pneumatic drive {(hydraulic or Pneumatic massages, [A61H 9/00](#); underwater massages, [A61H 33/00](#))}

References

Informative references

Attention is drawn to the following places, which may be of interest for search:

hydraulic or pneumatic drive not for percussion or vibration	<a href="#">A61H 2201/1238</a>
--	--------------------------------

**A61H 2023/045**

{using hydrostatic pressure, e.g. high density fluids}

**Definition statement**

*This place covers:*

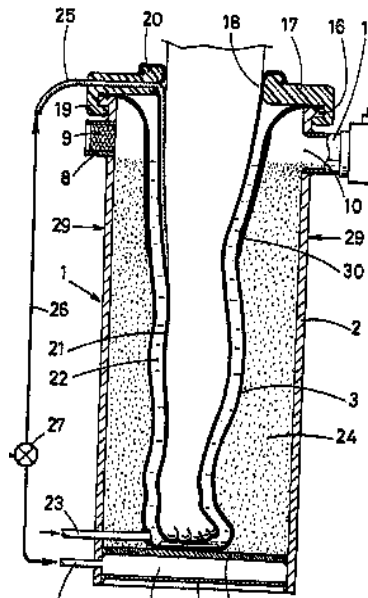

EP0181814

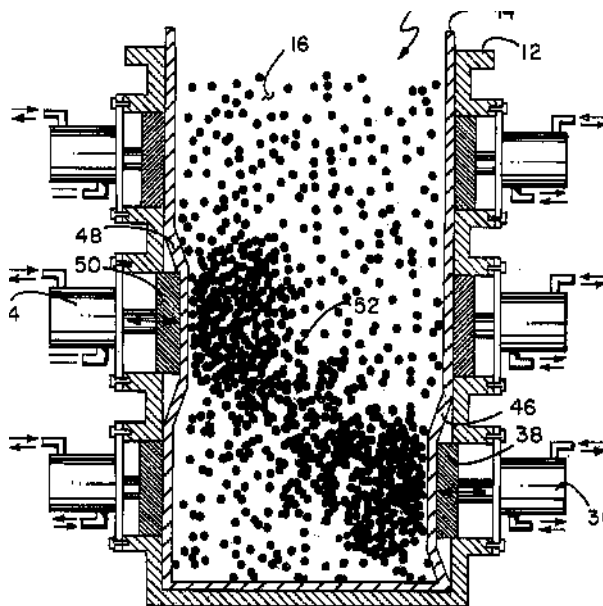

US6179797

**A61H 23/06**

Hand percussion {, i.e. Hand driven (chiropractic devices, [A61H 1/008](#), [A61H 1/006](#))}

**References****Limiting references**

*This place does not cover:*

Chiropractic devices	<a href="#">A61H 1/008</a> , <a href="#">A61H 1/006</a>
----------------------	---

**A61H 31/00**

Artificial respiration or heart stimulation, e.g. heart massage (artificial respiration by treatment with gas or air, e.g. mouth-to-mouth respiration [A61M 16/00](#); applying electric currents by contact electrodes for stimulation, e.g. heart pace-makers [A61N 1/36](#) {; teaching or training models, demonstration models for medical purposes [G09B 23/288](#))}

**Definition statement**

*This place covers:*

Apparatus or processes which are not used for surgical purposes utilizing mechanical energy transmitted by direct physical contact with the external surface of the thorax portion of human bodies to stimulate the heart in case of emergency or induce/supplement normal breathing (e.g. iron lungs)

**References****Limiting references**

*This place does not cover:*

Mouth-to-mouth respiration	<a href="#">A61M 16/00</a>
Heart pace-makers	<a href="#">A61N 1/36</a>
Rhythm indicators	<a href="#">G09B 23/288</a>

**Informative references**

*Attention is drawn to the following places, which may be of interest for search:*

Blood pumps	<a href="#">A61M 60/00</a>
-------------	----------------------------

**Special rules of classification**

For additional information the orthogonal classification ([A61H 2201/00](#), [A61H 2230/85](#)) is used.



A61H 2031/001

{fixed on the chest by suction}

References

Informative references

Attention is drawn to the following places, which may be of interest for search:

Suction cups used for fixing in active exercising devices	<a href="#">A63B 2225/055</a>
---	-------------------------------

A61H 2031/002

{fixed on the chest by adhesives}

References

Informative references

Attention is drawn to the following places, which may be of interest for search:

Adhesive type surfaces in active exercising devices	<a href="#">A63B 2209/10</a>
---	------------------------------

A61H 2031/003

{with alternated thorax decompression due to lateral compression}

Definition statement

This place covers:

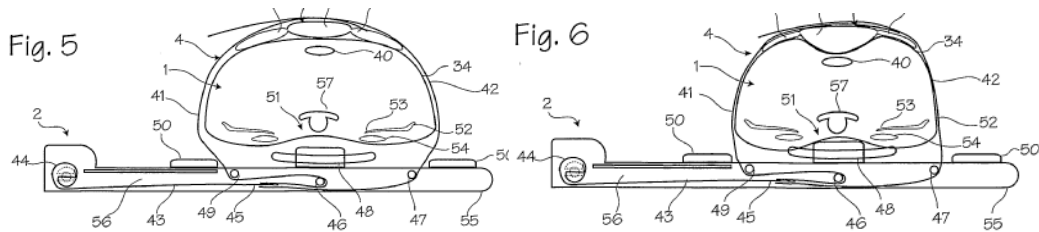

WO2004004548

A61H 31/004

{Heart stimulation}

Definition statement

This place covers:

Only for exterior mechanical heart stimulation

References

Informative references

Attention is drawn to the following places, which may be of interest for search:

Belt or strap expanding and contracting around an encircled body part	<a href="#">A61H 2011/005</a>
---	-------------------------------

**A61H 31/005****{with feedback for the user}****References****Informative references***Attention is drawn to the following places, which may be of interest for search:*

Control means - Interfaces to the user	<a href="#">A61H 2201/5023</a>
Artificial respiration with computer control	<a href="#">Y10S 601/08</a>

**A61H 31/006****{Power driven}****References****Informative references***Attention is drawn to the following places, which may be of interest for search:*

with electric or magnetic drive	<a href="#">A61H 2201/1207</a>
with hydraulic or pneumatic drive	<a href="#">A61H 2201/1238</a>

**A61H 31/007****{Manual driven}****References****Informative references***Attention is drawn to the following places, which may be of interest for search:*

Driven by human being	<a href="#">A61H 2201/1253</a>
-----------------------	--------------------------------

**A61H 31/008****{Supine patient supports or bases, e.g. improving air-way access to the lungs}****References****Informative references***Attention is drawn to the following places, which may be of interest for search:*

Patient in supine position	<a href="#">A61H 2203/0456</a>
----------------------------	--------------------------------

**A61H 31/02**

"Iron-lungs" {, i.e. involving chest expansion by applying underpressure thereon}, whether or not combined with gas breathing means

**References****Informative references**

Attention is drawn to the following places, which may be of interest for search:

Rooms for treatment of patients at over- or under-pressure or at a variable pressure	<a href="#">A61G 10/026</a>
Influencing respiratory system by gas treatment	<a href="#">A61M 16/00</a>
Active exercising at over- or under-pressure or at a variable pressure	<a href="#">A63B 2208/05</a>

**A61H 2031/025**

{using the same pump for pressure and vacuum, not being driven at the respiratory rate, e.g. blowers}

**References****Limiting references**

This place does not cover:

Driven at the respiratory rate	<a href="#">A61H 2230/425</a>
--------------------------------	-------------------------------

**A61H 33/00**

Bathing devices for special therapeutic or hygienic purposes ([A61H 35/00](#) takes precedence; {sprays acting on a body or body part not immersed in water [A61H 9/00](#); means for washing bed-ridden persons [A61G 7/0005](#);} for sub aquatic intestinal cleaning [A61M 9/00](#); {isolation chambers [A61M 21/0094](#); } electric or magnetic baths, applying ionised fluids [A61N 1/44](#) {; heater for bath tubs [F24H 1/54](#)})

**Definition statement**

This place covers:

Apparatus or processes which are not used for surgical purposes (e.g. baths) that are specially adapted for covering, soaking, or immersing human bodies, or portions of bodies, within fluids (e.g. steam, water) or fluent materials (e.g. sand, mud) in a manner that is distinct from the common bathing process for cleaning human bodies

**References****Limiting references**

This place does not cover:

Baths for specific parts of the body	<a href="#">A61H 35/00</a>
--------------------------------------	----------------------------

**Informative references**

Attention is drawn to the following places, which may be of interest for search:

Sprays acting on a body or a body part not immersed in water	<a href="#">A61H 9/00</a>
Bathing devices	<a href="#">A47K 3/02</a>
Means for washing bed-ridden persons	<a href="#">A61G 7/0005</a>
Means for sub-aquatic intestinal cleaning	<a href="#">A61M 9/00</a>
Isolation tanks	<a href="#">A61M 21/0094</a>
Devices for spraying media on the human body	<a href="#">A61M 35/00</a>
Electric or magnetic baths, applying ionised fluids	<a href="#">A61N 1/44</a>
Heater for bath tubs	<a href="#">F24H 1/54</a>

**Special rules of classification**

For additional information the orthogonal classification ([A61H 2201/00](#), [A61H 2230/85](#)) is used.

**A61H 2033/0004**

**{Bathing devices specially adapted for treating burned patients}**

**References****Informative references**

Attention is drawn to the following places, which may be of interest for search:

Baths for specific parts of the body	<a href="#">A61H 35/00</a>
Means for washing bed-ridden persons	<a href="#">A61G 7/0005</a>

**A61H 2033/0008**

**{Arrangement for cleaning the installation before or after use}**

**References****Informative references**

Attention is drawn to the following places, which may be of interest for search:

Machines for cleaning floors, furniture, walls, etc.	<a href="#">A47L 11/00</a>
Implements for cleaning floors, furniture, walls, etc.	<a href="#">A47L 13/00</a>

**A61H 2033/0012**

**{by rinsing}**

**Definition statement**

*This place covers:*

Without soap or with clean water to remove soap, detergent, dirt, or impurities.

**A61H 2033/0016****{using cleansing products}****Definition statement***This place covers:*

using specific products for thoroughly cleaning

**A61H 2033/002****{by blowing air through the installation after the bath has been emptied}****Definition statement***This place covers:*

In order to reduce residual water and reduce the possibility that bacteria and other pathogens may become present in the system.

**A61H 2033/0025****{by connecting the air lines with the drain}****Definition statement***This place covers:*

In order to reduce residual water and reduce the possibility that bacteria and other pathogens may become present in the system.

**A61H 2033/0029****{with ultrasonics}****References****Informative references***Attention is drawn to the following places, which may be of interest for search:*

Ultrasonic transducers for percussion or vibration massage	<a href="#">A61H 23/0245</a>
--	------------------------------

**A61H 2033/0033****{by draining-off pumps, nozzles, waterlines by gravity}****Definition statement***This place covers:*

In order to reduce residual water and reduce the possibility that bacteria and other pathogens may become present in the system.

A61H 2033/0037

{Arrangement for cleaning the fluid during use}

References

Limiting references

This place does not cover:

Treatment of water with magnetic or electric fields	<a href="#">C02F 1/48</a>
---	---------------------------

A61H 2033/0041

{Cleaning and recovery of the fluid without mixing the cleaned and uncleaned fluid, e.g. using a recovery tank}

Definition statement

This place covers:

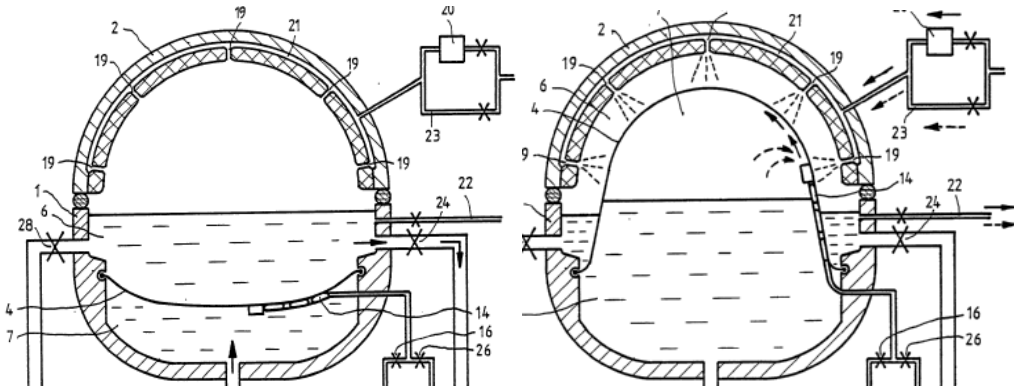

EP0356529

A61H 2033/0045

{with heat-recovery of waste fluid}

References

Informative references

Attention is drawn to the following places, which may be of interest for search:

Heated or cooled using heat exchangers (fresh/used fluids)	<a href="#">A61H 2201/0264</a>
--	--------------------------------

A61H 33/005

{Electrical circuits therefor}

References

Informative references

Attention is drawn to the following places, which may be of interest for search:

Non-electrical components therefore	<a href="#">A61H 33/60</a>
-------------------------------------	----------------------------

Control means	<a href="#">A61H 2201/50</a>
---------------	------------------------------

## A61H 2033/0054

{with liquid level detectors}

### References

#### Informative references

Attention is drawn to the following places, which may be of interest for search:

Other sensor	<a href="#">A61H 2201/5058</a>
--------------	--------------------------------

## A61H 2033/0058

{controlled by the user}

### References

#### Informative references

Attention is drawn to the following places, which may be of interest for search:

Control means - Interfaces to the user	<a href="#">A61H 2201/5023</a>
--	--------------------------------

## A61H 2033/0062

{with electro-pneumatic or -hydraulic switches}

### References

#### Informative references

Attention is drawn to the following places, which may be of interest for search:

Hydraulically controlled	<a href="#">A61H 2201/5051</a>
Pneumatically controlled	<a href="#">A61H 2201/5056</a>

## A61H 2033/0066

{with low-voltage switching, e.g. using optical isolators, isolated transformers}

### References

#### Informative references

Attention is drawn to the following places, which may be of interest for search:

Means for preventing injuries	<a href="#">A61H 2201/0173</a>
-------------------------------	--------------------------------

**A61H 2033/007****{with capacitors, e.g. proximity switches}****References****Informative references***Attention is drawn to the following places, which may be of interest for search:*

Limit switches	<a href="#">A61H 2201/5066</a>
----------------	--------------------------------

**A61H 2033/0075****{with opto-electric switches}****References****Informative references***Attention is drawn to the following places, which may be of interest for search:*

Optical sensors	<a href="#">A61H 2201/5092</a>
-----------------	--------------------------------

**A61H 2033/0079****{using remote control signal transmission devices, e.g. ultrasonic, infrared}****References****Informative references***Attention is drawn to the following places, which may be of interest for search:*

Wireless	<a href="#">A61H 2201/5097</a>
----------	--------------------------------

**A61H 2033/0083****{Illumination}****References****Informative references***Attention is drawn to the following places, which may be of interest for search:*

Illumination related features	<a href="#">A61H 2201/0188</a>
-------------------------------	--------------------------------

**A61H 33/0087****{Therapeutic baths with agitated or circulated water}****References****Limiting references***This place does not cover:*

Generating a current of water for swimming training	<a href="#">A63B 69/125</a>
---	-----------------------------



**Informative references**

Attention is drawn to the following places, which may be of interest for search:

Heated or cooled	<a href="#">A61H 2201/02</a>
------------------	------------------------------

**A61H 33/0091**

{Water agitated by means moving in the bath, i.e. without water connections to an outside pump circuit}

**Definition statement**

This place covers:

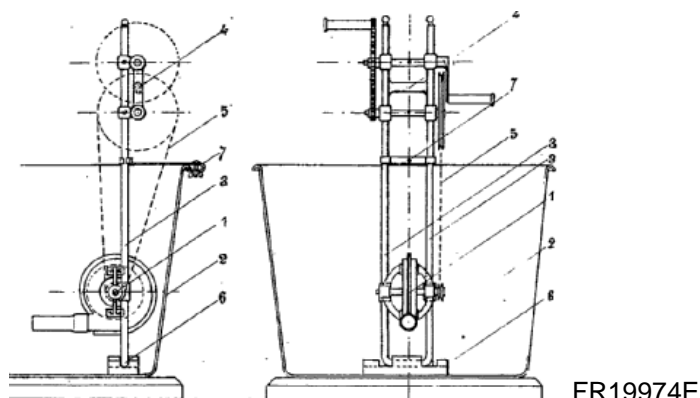

FR19974E

**A61H 33/0095**

{Arrangements for varying the temperature of the liquid}

**References****Informative references**

Attention is drawn to the following places, which may be of interest for search:

Heated or cooled	<a href="#">A61H 2201/02</a>
------------------	------------------------------

**A61H 33/02**

Bathing devices for use with gas-containing liquid, or liquid in which gas is led or generated, e.g. carbon dioxide baths {([A61H 33/6026](#) takes precedence)}

**References****Limiting references**

This place does not cover:

Nozzles in the bathtub connected to an outside pump circuit without modification of the bathtub walls	<a href="#">A61H 33/6026</a>
---	------------------------------

**A61H 2033/021****{Nozzles having flow-regulation means}****References****Informative references***Attention is drawn to the following places, which may be of interest for search:*

Control means	<a href="#">A61H 2201/50</a>
Nozzles in general	<a href="#">B05B 1/00</a>
Pool nozzles	<a href="#">E04H 4/169</a>

**A61H 2033/022****{with control means for regulating the air volume aspirated by a water jet}****References****Informative references***Attention is drawn to the following places, which may be of interest for search:*

Gas-water mixing nozzles	<a href="#">A61H 33/027</a>
Nozzles with flow regulating means	<a href="#">A61H 33/6052</a>

**A61H 2033/023****{with means in the air supply lines to prevent back-feed of water, e.g. anti-backflow valves, draining devices}****References****Informative references***Attention is drawn to the following places, which may be of interest for search:*

Components specifically designed therefor	<a href="#">A61H 33/60</a>
---	----------------------------

**A61H 33/025****{Aerating mats or frames, e.g. to be put in a bath-tub}****References****Informative references***Attention is drawn to the following places, which may be of interest for search:*

Components specifically designed for therefor	<a href="#">A61H 33/60</a>
---	----------------------------

**A61H 33/026****{Gas nozzles specially adapted therefor}****References****Informative references***Attention is drawn to the following places, which may be of interest for search:*

Nozzles in general	<a href="#">B05B 1/00</a>
Pool nozzles	<a href="#">E04H 4/169</a>

**A61H 33/027****{Gas-water mixing nozzles therefor}****References****Informative references***Attention is drawn to the following places, which may be of interest for search:*

with control means for regulating the air volume aspirated by a water jet	<a href="#">A61H 2033/022</a>
---	-------------------------------

**A61H 33/028****{Means for producing a flow of gas, e.g. blowers, compressors}****References****Informative references***Attention is drawn to the following places, which may be of interest for search:*

mixer provided with a venturi element	<a href="#">B01F 25/312</a>
---------------------------------------	-----------------------------

**A61H 33/04****Appliances for sand, mud {, wax} or foam baths; Appliances for metal baths, e.g. using metal salt solutions****References****Limiting references***This place does not cover:*

using fluids loaded with particles	<a href="#">A61H 2009/0014</a>
Baths	<a href="#">A47K 3/04</a>

**A61H 2033/041****{Baths with dry sand or other dry particles}****References****Limiting references***This place does not cover:*

using fluids loaded with particles	<a href="#">A61H 2009/0014</a>
Mud baths; Baths using sand or other particles in water	<a href="#">A61H 2033/046</a>
matresses with fluid-like particles	<a href="#">A61G 7/05738</a>

**A61H 2033/042****{gas-fluidised or gas-heated during use}****References****Informative references***Attention is drawn to the following places, which may be of interest for search:*

Heated or cooled	<a href="#">A61H 2201/02</a>
------------------	------------------------------

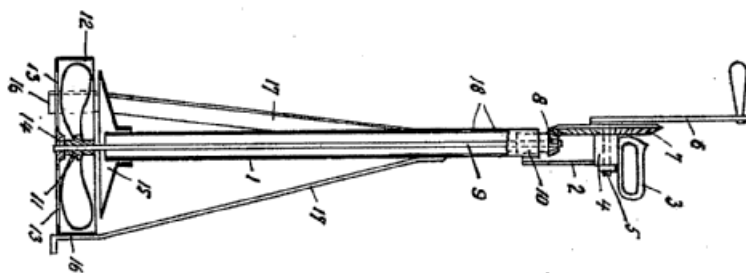
**A61H 2033/043****{Foam baths}****Definition statement***This place covers:*

CH146707

**A61H 2033/044****{Baths with herbs, e.g. infusions}****References****Informative references***Attention is drawn to the following places, which may be of interest for search:*

Massage by means of rollers and treatment with drugs	<a href="#">A61H 15/02</a>
Means for delivering media, e.g. drugs or cosmetics	<a href="#">A61H 2201/105</a>

**A61H 2033/045****{Liquid-metal baths}****References****Informative references***Attention is drawn to the following places, which may be of interest for search:*

Hydraulic massage with particles, e.g. sand	<a href="#">A61H 2009/0014</a>
Baths with dry sand or other dry particles	<a href="#">A61H 2033/041</a>

**A61H 2033/046****{Mud baths; Baths using sand or other particles in water}****References****Informative references***Attention is drawn to the following places, which may be of interest for search:*

Hydraulic massage with particles, e.g. sand	<a href="#">A61H 2009/0014</a>
Baths with dry sand or other dry particles	<a href="#">A61H 2033/041</a>

**A61H 2033/048****{Baths using solutions, e.g. salts}****References****Informative references***Attention is drawn to the following places, which may be of interest for search:*

Hydraulic massage with particles, e.g. sand	<a href="#">A61H 2009/0014</a>
Massage by means of rollers and treatment with drugs	<a href="#">A61H 15/02</a>
Baths with dry sand or other dry particles	<a href="#">A61H 2033/041</a>
Mud baths; Baths using sand or other particles in water	<a href="#">A61H 2033/046</a>
Means for delivering media, e.g. drugs or cosmetics	<a href="#">A61H 2201/105</a>

**A61H 33/06****Artificial hot-air or cold-air baths; Steam or gas baths or douches, e.g. sauna or Finnish baths {(artificial climate rooms [A61G 10/02](#))}****References****Informative references***Attention is drawn to the following places, which may be of interest for search:*

Components specifically designed therefor	<a href="#">A61H 33/60</a>
Heated or cooled	<a href="#">A61H 2201/02</a>

Heating cooling appliances for medical or therapeutic use	<a href="#">A61F 7/00</a>
Treatment room with artificial climate	<a href="#">A61G 10/02</a>

## A61H 2033/061

{Artificial hot-air baths}

### References

#### Informative references

Attention is drawn to the following places, which may be of interest for search:

Heated	<a href="#">A61H 2201/0207</a>
--------	--------------------------------

## A61H 2033/062

{Artificial cold-air baths}

### References

#### Informative references

Attention is drawn to the following places, which may be of interest for search:

Cooled	<a href="#">A61H 2201/0214</a>
--------	--------------------------------

## A61H 33/063

{Heaters specifically designed therefor}

### Definition statement

*This place covers:*

Specifically designed for Artificial hot-air or cold-air baths; Steam or gas baths or douches, e.g. sauna or Finnish baths

### References

#### Limiting references

*This place does not cover:*

Steam boilers	<a href="#">F22B 29/00</a>
---------------	----------------------------

## A61H 33/065

{with steam generators}

### References

#### Informative references

Attention is drawn to the following places, which may be of interest for search:

Mechanism for heating or cooling	<a href="#">A61H 2201/0221</a>
----------------------------------	--------------------------------

**A61H 33/066****{Cabins therefor}****References****Informative references***Attention is drawn to the following places, which may be of interest for search:*

Further components specifically designed therefor	<a href="#">A61H 33/60</a>
---	----------------------------

**A61H 33/067****{Installations for the inside of such cabins, e.g. seats}****References****Informative references***Attention is drawn to the following places, which may be of interest for search:*

Further components specifically designed therefor	<a href="#">A61H 33/60</a>
---	----------------------------

**A61H 2033/068****{Steam baths}****References****Limiting references***This place does not cover:*

Steam baths for the face	<a href="#">A61H 33/12</a>
Steam boilers	<a href="#">F22B 29/00</a>

**A61H 33/08****Air douches for hygienic purposes (hair-driers [A45D 20/00](#); body-drying devices [A47K 10/48](#); electric heating elements [H05B](#))****References****Limiting references***This place does not cover:*

Heated	<a href="#">A61H 2201/0207</a>
Cooled	<a href="#">A61H 2201/0214</a>
Mechanism for heating or cooling	<a href="#">A61H 2201/0221</a>
Hair-driers	<a href="#">A45D 20/00</a>
Body-drying devices	<a href="#">A47K 10/48</a>
Inhalators <a href="#">A61M 15/009</a>	<a href="#">A61M 15/009</a>

**A61H 33/10****Devices on tubs for steam baths****Definition statement**

*This place covers:*

bathtub covers e.g. for steam baths

**A61H 33/12****Steam baths for the face****References****Informative references**

*Attention is drawn to the following places, which may be of interest for search:*

Steam baths	<a href="#">A61H 2033/068</a>
-------------	-------------------------------

**A61H 33/14****Devices for gas baths with ozone, hydrogen, or the like (production of ozone or hydrogen [C01B](#), [C25B 1/02](#))****References****Limiting references**

*This place does not cover:*

Production of Hydrogen	<a href="#">C01B 3/00</a>
Production of Ozone	<a href="#">C01B 13/00</a>
Apparatuses for separating the constituents of gaseous mixtures by liquefaction or solidification	<a href="#">F25J 3/00</a>

**Informative references**

*Attention is drawn to the following places, which may be of interest for search:*

Sealing means for masks	<a href="#">A61M 16/0627</a>
-------------------------	------------------------------

**A61H 2033/141****{with ionised gas, e.g. ozone}****References****Limiting references**

*This place does not cover:*

Production of Ozone	<a href="#">C01B 13/00</a>
---------------------	----------------------------



**A61H 2033/143**

{with oxygen}

**References**

**Limiting references**

*This place does not cover:*

Production of Oxygen	<a href="#">C01B 13/00</a>
----------------------	----------------------------

**A61H 2033/145**

{with CO<sub>2</sub>}

**References**

**Limiting references**

*This place does not cover:*

Production of CO2	<a href="#">C01B 32/50</a>
-------------------	----------------------------

**A61H 2033/146**

{with nitrogen}

**References**

**Limiting references**

*This place does not cover:*

Production of Nitrogen	<a href="#">C01B 21/00</a>
------------------------	----------------------------

**A61H 2033/148**

{with hydrogen}

**References**

**Limiting references**

*This place does not cover:*

Production of Hydrogen	<a href="#">C01B 3/00</a>
------------------------	---------------------------

## A61H 33/60

{Components specifically designed for the therapeutic baths of groups  
[A61H 33/00](#) (plumbing [E03C 1/00](#))}

### References

#### Limiting references

*This place does not cover:*

Plumbing in general	<a href="#">E03C 1/00</a>
Heaters for bath tubes	<a href="#">F24H 1/54</a>

## A61H 33/6005

{Special constructive structural details of the bathtub, e.g. of the walls or supporting structure}

### Definition statement

*This place covers:*

- Specific construction of the walls or the supporting structure of a bathtub
- Specific layout of the bathtub or the seats in it
- Specific materials or dimensions.
- Specific constructive aspects of bathtubs not covered by the other classes of [A61H 33/0087](#), [A61H 33/02](#), [A61H 33/04](#), [A61H 33/06](#)

## A61H 33/601

{Inlet to the bath}

### Definition statement

*This place covers:*

To take water into the bathtub

### References

#### Informative references

*Attention is drawn to the following places, which may be of interest for search:*

for use with gas-containing liquid	<a href="#">A61H 33/02</a>
------------------------------------	----------------------------

A61H 33/6015

{Cascade massage}

Definition statement

This place covers:

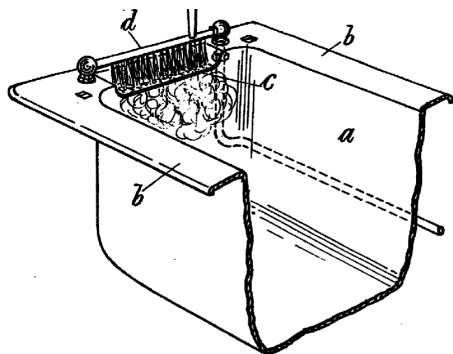

GB463284

A61H 33/6021

{Nozzles}

Definition statement

This place covers:

Nozzles specifically designed for the therapeutic baths of groups [A61H 33/0087](#), [A61H 33/02](#), [A61H 33/04](#) and [A61H 33/06](#)

References

Limiting references

This place does not cover:

Nozzles for use with gas-containing liquid	<a href="#">A61H 33/02</a>
Nozzles in general	<a href="#">B05B 1/00</a>
Pool nozzles	<a href="#">E04H 4/169</a>

A61H 33/6026

{Nozzles in the bathtub connected to an outside pump circuit without modification of the walls}

References

Informative references

Attention is drawn to the following places, which may be of interest for search:

Aerating mats or frames, e.g. to be put in a bath-tub	<a href="#">A61H 33/025</a>
---	-----------------------------

**A61H 33/6031****{Extendible or retractable}****References****Informative references***Attention is drawn to the following places, which may be of interest for search:*

Control means	<a href="#">A61H 2201/50</a>
---------------	------------------------------

**A61H 33/6036****{Hand-held connected to a supply hose}****References****Informative references***Attention is drawn to the following places, which may be of interest for search:*

Handheld suction-kneading massage, power driven	<a href="#">A61H 7/005</a>
Handheld massage by means of rollers, balls, power driven	<a href="#">A61H 15/0085</a>
Handheld massage by means of rollers, balls	<a href="#">A61H 15/0092</a>
Handheld	<a href="#">A61H 2201/0153</a>

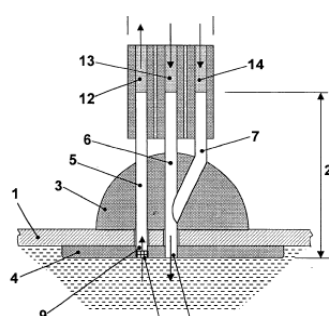
**A61H 33/6042****{Used also as outlet}****Definition statement***This place covers:*

EP1293189

**A61H 33/6047****{With incorporated pump means}****References****Limiting references***This place does not cover:*

Recirculating pumps for swimming pool water	<a href="#">E04H 4/1245</a>
---	-----------------------------

**A61H 33/6052****{Having flow regulating means}****References****Informative references***Attention is drawn to the following places, which may be of interest for search:*

Nozzles with control means for regulating the air volume aspirated by water jet	<a href="#">A61H 2033/022</a>
---	-------------------------------

**A61H 33/6057****{Comprising means producing pulsating or intermittent streams (for massage, [A61H 9/0007](#))}****References****Limiting references***This place does not cover:*

Pulsating or intermittent streams for massage	<a href="#">A61H 9/0007</a>
---	-----------------------------

**A61H 33/6063****{Specifically adapted for fitting in bathtub walls}****References****Limiting references***This place does not cover:*

Generating a current of water for swimming training	<a href="#">A63B 69/125</a>
---	-----------------------------

**A61H 33/6068****{Outlet from the bath}****Definition statement***This place covers:*

To drain water from the bathtub

**A61H 33/6073****{Intake mouths for recirculation of fluid in whirlpool baths}****Definition statement***This place covers:*

To drain water from the bathtub to a recirculation system

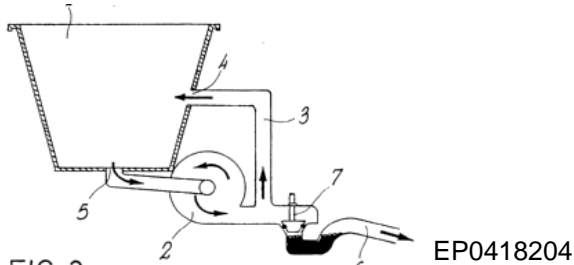
**A61H 33/6078****{Combined with waste outlets}****Definition statement***This place covers:***A61H 33/6084****{For filling to the border or edge of the bath, i.e. no border to be seen}****References****Limiting references***This place does not cover:*

Circumferential gutters for swimming pools	<a href="#">E04H 4/1227</a>
--	-----------------------------

**A61H 33/6089****{Specific construction features for further massaging means, i.e. not for the nozzles}****Definition statement***This place covers:*

Comprising the hydraulic massage brought around by the nozzles of the bathtub and also further massage means

**A61H 33/6094****{Extending through the wall of the bathing device}****Definition statement***This place covers:*

The walls of the bathing tub being provided with apertures for the further massaging means

## A61H 35/00

**Baths for specific parts of the body {(electric circuits therefor [A61H 33/005](#); specific components therefor [A61H 33/60](#))}**

### Definition statement

*This place covers:*

Apparatus or processes which are not used for surgical purposes (e.g. baths) that are specially adapted for covering, soaking, or immersing specific portions of bodies, within fluids (e.g. steam, water) or fluent materials (e.g. sand, mud) for specific therapeutic purposes, in a manner that is distinct from the common bathing process for cleaning human bodies

### References

#### Informative references

*Attention is drawn to the following places, which may be of interest for search:*

Devices for specific parts of the body	<a href="#">A61H 2205/00</a>
Bidets without upward-spraying means	<a href="#">A47K 3/26</a>
Showers	<a href="#">A47K 3/28</a>
Body washing or cleaning	<a href="#">A47K 7/00</a>
Irrigators	<a href="#">A61M 3/02</a>
Devices for sub aquatic intestinal cleaning	<a href="#">A61M 9/00</a>
Domestic plumbing	<a href="#">E03C 1/00</a>

### Special rules of classification

Components specifically designed for the therapeutic baths of this groups are classified in [A61H 33/60](#)

For additional information the orthogonal classification ([A61H 2201/00](#), [A61H 2230/85](#)) is used.

## A61H 35/002

**{Breast baths}**

### References

#### Informative references

*Attention is drawn to the following places, which may be of interest for search:*

Devices for the breast	<a href="#">A61H 2205/082</a>
------------------------	-------------------------------

**A61H 2035/004****{for the whole body except the head}****References****Limiting references***This place does not cover:*

Bathing devices for special therapeutic or hygienic purposes for the whole body	<a href="#">A61H 33/00</a>
---	----------------------------

**A61H 35/006****{for the feet}****References****Informative references***Attention is drawn to the following places, which may be of interest for search:*

Devices for the feet	<a href="#">A61H 2205/12</a>
Implements for cleaning the feet or toes	<a href="#">A47K 7/026</a>

**A61H 35/008****{for the head ([A61H 35/02](#) and [A61H 35/04](#) takes precedence)}****References****Informative references***Attention is drawn to the following places, which may be of interest for search:*

Devices for the head	<a href="#">A61H 2205/02</a>
----------------------	------------------------------

**A61H 35/02****for the eyes****Definition statement***This place covers:*

Limited to real baths (pools)

**References****Limiting references***This place does not cover:*

for introducing droplets in the eyes	<a href="#">A61F 9/0008</a>
--------------------------------------	-----------------------------



**Informative references**

Attention is drawn to the following places, which may be of interest for search:

Devices for the eyes	<a href="#">A61H 2205/024</a>
----------------------	-------------------------------

**A61H 35/04**

**for the nose**

**References****Informative references**

Attention is drawn to the following places, which may be of interest for search:

Massage devices for cavities, e.g. nose	<a href="#">A61H 21/00</a>
Devices for the nose	<a href="#">A61H 2205/023</a>
Inhalators	<a href="#">A61M 15/009</a>

**A61H 36/00**

**Sweating suits**

**Definition statement**

*This place covers:*

Articles of clothing that at least partially enclose human bodies for the primary purpose of increasing the local temperature (e.g. insulated, include heating elements) or humidity (e.g. constructed of partially air tight material) of the portion of the human bodies covered to a point where the localized temperature or humidity is beyond the range that human beings normally consider physically comfortable (i.e. creates localized sauna-like environment)

**Special rules of classification**

For additional information the orthogonal classification ([A61H 2201/00](#), [A61H 2230/85](#)) is used.

**A61H 37/00**

**Accessories for massage**

**Definition statement**

*This place covers:*

Specially adapted components for the above types of apparatus (e.g. body floating supports for relaxation in water).

**Special rules of classification**

For additional information the orthogonal classification ([A61H 2201/00](#), [A61H 2230/85](#)) is used.

**A61H 37/005****{Body floating supports for relaxation in water}****References****Limiting references***This place does not cover:*

Swimming boards	<a href="#">A63B 69/14</a>
Life-buoys, life-belts	<a href="#">B63C 9/08</a>

**A61H 39/00**

Devices for locating or stimulating specific reflex points of the body for physical therapy, e.g. acupuncture (chiropodists' instruments [A61B 17/54](#); {for radiation therapy [A61N 5/0619](#)})

**Definition statement***This place covers:*

Auxiliary appliances or accessories specially adapted for locating and stimulating specific reflex points, as typically known from the Traditional Chinese Medicine (TCM).

**References****Informative references***Attention is drawn to the following places, which may be of interest for search:*

Footwear with acupressure points	<a href="#">A43B 7/146</a>
Chiropodist's instruments	<a href="#">A61B 17/54</a>

**Special rules of classification**

For additional information the orthogonal classification ([A61H 2201/00](#), [A61H 2230/85](#)) is used.

**A61H 39/002****{Using electric currents (electrotherapy [A61N 1/32](#))}****References****Informative references***Attention is drawn to the following places, which may be of interest for search:*

further special therapeutic means, e.g. electrotherapy	<a href="#">A61H 2201/10</a>
Electrotherapy	<a href="#">A61N 1/00</a>
Electrotherapy combined with active exercising	<a href="#">A63B 2213/004</a>

**A61H 2039/005****{by means of electromagnetic waves, e.g. I.R., U.V. rays}****References****Informative references***Attention is drawn to the following places, which may be of interest for search:*

Magnetotherapy	<a href="#">A61N 2/00</a>
Radiation therapy	<a href="#">A61N 5/00</a>
Radiation by LEDs	<a href="#">A61N 2005/0651</a>
Infrared	<a href="#">A61N 2005/0659</a>
Ultraviolet	<a href="#">A61N 2005/0661</a>
Chromotherapy	<a href="#">A61N 2005/0663</a>

**A61H 39/007****{Stimulation by mechanical vibrations, e.g. ultrasonic}****References****Informative references***Attention is drawn to the following places, which may be of interest for search:*

Ultrasonic transducers for vibration massage	<a href="#">A61H 23/0245</a>
--	------------------------------

**A61H 39/02****Devices for locating such points****References****Informative references***Attention is drawn to the following places, which may be of interest for search:*

Measuring impedance, e.g. skin conductivity	<a href="#">A61H 2230/65</a>
---	------------------------------

**A61H 39/04****Devices for pressing such points, e.g. Shiatsu {or Acupressure} (Massage or pressure on general areas [A61H 9/00](#) - [A61H 23/00](#))****References****Limiting references***This place does not cover:*

Massage without substantial movement between the skin and the device	<a href="#">A61H 7/001</a>
--	----------------------------

**Informative references**

Attention is drawn to the following places, which may be of interest for search:

For specific parts of the body	<a href="#">A61H 2205/00</a>
--------------------------------	------------------------------

**A61H 39/06**

Devices for heating or cooling such points within cell-life limits (cauterisers, moxaburners, cryogenic apparatus [A61B 18/06](#); heating or cooling appliances for medical treatment of general areas of the human body [A61F 7/00](#))

**References****Informative references**

Attention is drawn to the following places, which may be of interest for search:

Heaters for hot-air baths	<a href="#">A61H 33/063</a>
Heating or cooling	<a href="#">A61H 2201/02</a>
Heating cooling appliances for medical or therapeutic use	<a href="#">A61F 7/00</a>
Control of temperature	<a href="#">G05D 23/00</a>

**A61H 39/08**

Devices for applying needles to such points, i.e. for acupuncture {;  
Acupuncture needles or accessories therefor}

**References****Informative references**

Attention is drawn to the following places, which may be of interest for search:

For specific parts of the body	<a href="#">A61H 2205/00</a>
--------------------------------	------------------------------

**A61H 39/083**

{Needle tubes}

**References****Informative references**

Attention is drawn to the following places, which may be of interest for search:

Protective casings for instruments for surgery or diagnosis	<a href="#">A61B 50/00</a>
Packages specially adapted for needles	<a href="#">A61M 5/002</a>

**A61H 39/086****{Acupuncture needles}****References****Informative references***Attention is drawn to the following places, which may be of interest for search:*

Needles	<a href="#">A61M 5/00</a>
---------	---------------------------

**A61H 99/00****Subject matter not provided for in other groups of this subclass****Definition statement***This place covers:*

General massage methods without technical means, non patentable per se, are classified here

**Special rules of classification**For additional information the orthogonal classification ([A61H 2201/00](#), [A61H 2230/85](#)) is used.**A61H 2201/00****Characteristics of apparatus not provided for in the preceding codes****Definition statement***This place covers:*

Classes which are used for refining the preceding scheme

**A61H 2201/01****Constructive details****Definition statement***This place covers:*

Classes which are used for specifying the constructive details not defined in the preceding scheme

**A61H 2201/0103****inflatable****References****Limiting references***This place does not cover:*

inflated cuffs	<a href="#">A61H 9/0078</a>
----------------	-----------------------------

**Informative references**

Attention is drawn to the following places, which may be of interest for search:

Beds for nursing with inflatable chambers	<a href="#">A61G 7/05769</a>
inflatable active exercising devices	<a href="#">A63B 2225/62</a>

**A61H 2201/0107****modular****Definition statement**

*This place covers:*

Employing or involving modules in design or construction.

**References****Limiting references**

*This place does not cover:*

Interchangeable interface surface	<a href="#">A61H 2201/1685</a>
-----------------------------------	--------------------------------

**A61H 2201/0111****watertight****References****Informative references**

Attention is drawn to the following places, which may be of interest for search:

Surface of the interface	<a href="#">A61H 2201/1683</a>
--------------------------	--------------------------------

**A61H 2201/0115****used in water****References****Informative references**

Attention is drawn to the following places, which may be of interest for search:

The patient being immersed in liquid	<a href="#">A61H 2203/02</a>
--------------------------------------	------------------------------

**A61H 2201/0119****Support for the device****Definition statement**

*This place covers:*

Anchorage or support for the device during use

## References

### Informative references

Attention is drawn to the following places, which may be of interest for search:

For active exercising	<a href="#">A63B 21/16</a>
-----------------------	----------------------------

## A61H 2201/0123

on a door

## References

### Informative references

Attention is drawn to the following places, which may be of interest for search:

For active exercising	<a href="#">A63B 21/1627</a>
-----------------------	------------------------------

## Glossary of terms

In this place, the following terms or expressions are used with the meaning indicated:

Jamb	frame of the door
------	-------------------

## A61H 2201/0126

on a wall

## References

### Informative references

Attention is drawn to the following places, which may be of interest for search:

For active exercising	<a href="#">A63B 21/169</a>
-----------------------	-----------------------------

## A61H 2201/013

Suction cups

## References

### Informative references

Attention is drawn to the following places, which may be of interest for search:

Suction cups for massaging	<a href="#">A61H 2009/0064</a>
Suction cups for active exercising devices	<a href="#">A63B 2225/05</a>

**A61H 2201/0134****Cushion or similar support****References****Informative references***Attention is drawn to the following places, which may be of interest for search:*

For active exercising	<a href="#">A63B 2210/00</a>
-----------------------	------------------------------

**A61H 2201/0138****incorporated in furniture****References****Informative references***Attention is drawn to the following places, which may be of interest for search:*

For active exercising	<a href="#">A63B 2210/00</a>
-----------------------	------------------------------

**A61H 2201/0142****Beds****References****Informative references***Attention is drawn to the following places, which may be of interest for search:*

Sofas, Couches, Beds	<a href="#">A47C 17/00</a>
Beds for nursing	<a href="#">A61G 7/00</a>
For active exercising	<a href="#">A63B 2210/04</a>

**A61H 2201/0146****Mattresses****References****Informative references***Attention is drawn to the following places, which may be of interest for search:*

Beds for nursing	<a href="#">A61G 7/00</a>
------------------	---------------------------



**A61H 2201/0149****Seat or chair****References****Informative references**

*Attention is drawn to the following places, which may be of interest for search:*

Chairs	<a href="#">A47C 1/00</a>
For active exercising	<a href="#">A63B 2210/02</a>
Massaging seats for vehicles	<a href="#">B60N 2/976</a>

**A61H 2201/0153****hand-held****Definition statement**

*This place covers:*

The whole device being hand-held, not just the interface

**References****Informative references**

*Attention is drawn to the following places, which may be of interest for search:*

Handheld suction-kneading massage, power driven	<a href="#">A61H 7/005</a>
Handheld massage by means of rollers, balls, power driven	<a href="#">A61H 15/0085</a>
Handheld massage by means of rollers, balls	<a href="#">A61H 15/0092</a>
Hand-held nozzles	<a href="#">A61H 33/6036</a>

**A61H 2201/0157****portable****Definition statement**

*This place covers:*

Build to be easily carried or moved

**References****Limiting references**

*This place does not cover:*

Handheld or hand-driven device for rubbing or brushing	<a href="#">A61H 7/003</a>
Handheld suction-kneading massage, power driven	<a href="#">A61H 7/005</a>
Handheld massage by means of rollers, balls, power driven	<a href="#">A61H 15/0085</a>
Handheld massage by means of rollers, balls	<a href="#">A61H 15/0092</a>
Handheld	<a href="#">A61H 2201/0153</a>

Wearable interface	<a href="#">A61H 2201/165</a>
--------------------	-------------------------------

### **Informative references**

Attention is drawn to the following places, which may be of interest for search:

Size reducing arrangements	<a href="#">A61H 2201/0161</a>
----------------------------	--------------------------------

## **A61H 2201/0161**

### **Size reducing arrangements when not in use, for stowing or transport**

### **References**

#### **Informative references**

Attention is drawn to the following places, which may be of interest for search:

Folding or stowable tables	<a href="#">A47B 3/00</a>
Foldable chairs	<a href="#">A47C 4/00</a>
Size reducing for active exercising apparatus	<a href="#">A63B 2210/00</a>

## **A61H 2201/0165**

### **Damping, vibration related features**

### **References**

#### **Informative references**

Attention is drawn to the following places, which may be of interest for search:

Shock absorbers for active exercising	<a href="#">A63B 2071/0063</a>
---------------------------------------	--------------------------------

## **A61H 2201/0169**

### **Noise reduction**

### **Definition statement**

This place covers:

by controlling the vibration

## **A61H 2201/0173**

### **Means for preventing injuries**

### **References**

#### **Informative references**

Attention is drawn to the following places, which may be of interest for search:

For active exercising	<a href="#">A63B 71/0054</a>
-----------------------	------------------------------

**A61H 2201/0176****By stopping operation****References****Informative references***Attention is drawn to the following places, which may be of interest for search:*

For active exercising	<a href="#">A63B 2071/0081</a>
-----------------------	--------------------------------

**A61H 2201/018****By limiting the applied torque or force****References****Informative references***Attention is drawn to the following places, which may be of interest for search:*

For active exercising	<a href="#">A63B 2071/0072</a>
-----------------------	--------------------------------

**A61H 2201/0184****by raising an alarm****References****Informative references***Attention is drawn to the following places, which may be of interest for search:*

Interface to the user	<a href="#">A61H 2201/5023</a>
-----------------------	--------------------------------

**A61H 2201/0188****Illumination related features****References****Limiting references***This place does not cover:*

Illumination in bathing devices	<a href="#">A61H 2033/0083</a>
---------------------------------	--------------------------------

**A61H 2201/0192****Specific means for adjusting dimensions****References****Informative references***Attention is drawn to the following places, which may be of interest for search:*

For active exercising	<a href="#">A63B 2225/09</a>
-----------------------	------------------------------

**A61H 2201/0196****automatically adjusted according to anthropometric data of the user****References****Informative references***Attention is drawn to the following places, which may be of interest for search:*

For active exercising	<a href="#">A63B 2225/096</a>
-----------------------	-------------------------------

**A61H 2201/02****heated or cooled****Definition statement***This place covers:*

Heating or cooling for massage purposes, not for a correct functioning of the device

**References****Informative references***Attention is drawn to the following places, which may be of interest for search:*

Heaters for hot-air baths	<a href="#">A61H 33/063</a>
Heating cooling appliances for medical or therapeutic use	<a href="#">A61F 7/00</a>
Control of temperature	<a href="#">G05D 23/00</a>

**A61H 2201/0207****heated****References****Informative references***Attention is drawn to the following places, which may be of interest for search:*

warming pads for medical or therapeutic use	<a href="#">A61F 7/08</a>
For active exercising	<a href="#">A63B 2225/64</a>
Heated bath tubs	<a href="#">F24H 1/0072</a>

**A61H 2201/0214****cooled****References****Informative references***Attention is drawn to the following places, which may be of interest for search:*

Cooling bags for medical or therapeutic use	<a href="#">A61F 7/10</a>
---	---------------------------

For active exercising	<a href="#">A63B 2225/66</a>
-----------------------	------------------------------

## A61H 2201/0221

### Mechanism for heating or cooling

#### References

##### Informative references

Attention is drawn to the following places, which may be of interest for search:

Heaters for hot-air baths	<a href="#">A61H 33/063</a>
Control means	<a href="#">A61H 2201/50</a>
Temperature sensors	<a href="#">A61H 2201/5082</a>
Heating cooling appliances for medical or therapeutic use	<a href="#">A61F 7/00</a>
Control of temperature	<a href="#">G05D 23/00</a>

## A61H 2201/0228

### heated by an electric resistance element

#### References

##### Informative references

Attention is drawn to the following places, which may be of interest for search:

Electric heating for medical or therapeutic use	<a href="#">A61F 7/007</a>
---	----------------------------

## A61H 2201/0235

### Thermistors with Positive Temperature Coefficient [PTC]

#### References

##### Informative references

Attention is drawn to the following places, which may be of interest for search:

PTC non-adjustable resistors	<a href="#">H01C 7/02</a>
------------------------------	---------------------------

## A61H 2201/0242

### by a fluid circulating in the apparatus

#### Definition statement

This place covers:

within the apparatus, not on the user

**A61H 2201/025****by direct air flow on the patient's body****References****Limiting references***This place does not cover:*

Gas-fluidised or -heated sand baths	<a href="#">A61H 2033/042</a>
Artificial hot-air baths	<a href="#">A61H 2033/061</a>

**Informative references***Attention is drawn to the following places, which may be of interest for search:*

hot or cold fluid for medical or therapeutic use	<a href="#">A61F 7/0053</a> , <a href="#">A61F 7/0085</a>
--	--

**A61H 2201/0257****by a heat accumulator, e.g. a sand or liquid reservoir****References****Informative references***Attention is drawn to the following places, which may be of interest for search:*

Appliances for sand, mud, or foam baths	<a href="#">A61H 33/04</a>
---	----------------------------

**A61H 2201/0264****using heat exchanger, e.g. between fresh and used fluids****References****Limiting references***This place does not cover:*

Bathing or washing device with waste-fluid-heat recovery	<a href="#">A61H 2033/0045</a>
--	--------------------------------

**A61H 2201/0278****by chemical reaction****References****Informative references***Attention is drawn to the following places, which may be of interest for search:*

Heat by chemical reaction for medical or therapeutic use	<a href="#">A61F 7/03</a>
--	---------------------------

**A61H 2201/0285****with Peltier elements****References****Informative references***Attention is drawn to the following places, which may be of interest for search:*

Air-conditioning devices using Peltier effect	<a href="#">B60H 1/00478</a>
Machines cooling with Peltier effect	<a href="#">F25B 21/00</a>
Thermo-electric devices using Peltier effect	<a href="#">H10N 10/10</a>

**A61H 2201/0292****with microwaves****References****Informative references***Attention is drawn to the following places, which may be of interest for search:*

Microwaves for heating fluids	<a href="#">H05B 6/80</a>
-------------------------------	---------------------------

**A61H 2201/10****with further special therapeutic means, e.g. electrotherapy, magneto therapy or radiation therapy, chromo therapy, infrared or ultraviolet therapy****References****Limiting references***This place does not cover:*

Electrotherapy for causing a change in the consciousness	<a href="#">A61M 2021/0072</a>
--	--------------------------------

**Informative references***Attention is drawn to the following places, which may be of interest for search:*

Heated or cooled	<a href="#">A61H 2201/02</a>
Heating cooling appliances for medical or therapeutic use	<a href="#">A61F 7/00</a>
Aromatherapy	<a href="#">A61M 2021/0016</a>
Electrotherapy	<a href="#">A61N 1/00</a>
Magnetotherapy	<a href="#">A61N 2/00</a>
Radiation therapy	<a href="#">A61N 5/00</a>
Radiation by LEDs	<a href="#">A61N 2005/0651</a>
Infrared	<a href="#">A61N 2005/0659</a>
Ultraviolet	<a href="#">A61N 2005/0661</a>
Chromotherapy	<a href="#">A61N 2005/0663</a>

Preparations for care of the skin	<a href="#">A61Q 19/00</a>
Electrotherapy combined with active exercising	<a href="#">A63B 2213/004</a>

## A61H 2201/102

with aromatherapy

### References

#### Informative references

Attention is drawn to the following places, which may be of interest for search:

Aromatherapy	<a href="#">A61M 2021/0016</a>
--------------	--------------------------------

## A61H 2201/105

with means for delivering media, e.g. drugs or cosmetics

### References

#### Informative references

Attention is drawn to the following places, which may be of interest for search:

Appliances specially adapted for applying liquid, e.g. using roller or ball	<a href="#">A45D 34/04</a>
---	----------------------------

## A61H 2201/107

Respiratory gas

### References

#### Limiting references

This place does not cover:

Respiratory gas for active exercising	<a href="#">A63B 2213/005</a>
---------------------------------------	-------------------------------

## A61H 2201/12

Driving means

### References

#### Limiting references

This place does not cover:

Special force transmission means	<a href="#">A61H 2201/14</a>
Physical interface with the patient	<a href="#">A61H 2201/16</a>



**Informative references**

Attention is drawn to the following places, which may be of interest for search:

Vibration driving means	<a href="#">A61H 23/00</a>
-------------------------	----------------------------

**A61H 2201/1207**

with electric or magnetic drive

**References****Informative references**

Attention is drawn to the following places, which may be of interest for search:

Vibration electric or magnetic driving means	<a href="#">A61H 23/02</a>
--	----------------------------

**A61H 2201/1215**

Rotary drive

**References****Informative references**

Attention is drawn to the following places, which may be of interest for search:

Vibration electric or magnetic rotary driving means	<a href="#">A61H 23/0254</a>
---	------------------------------

**A61H 2201/1223**

Frequency controlled AC motor

**References****Informative references**

Attention is drawn to the following places, which may be of interest for search:

Vibration driving means powered with frequencies not related to mains frequency	<a href="#">A61H 2023/0209</a>
---	--------------------------------

**A61H 2201/123**

Linear drive

**Definition statement**

This place covers:

Unit containing a rotary drive and a conversion system transforming the rotation in a linear movement, e.g. screw-jack

## References

### Limiting references

*This place does not cover:*

Movement conversion means separated from the drive unit	<a href="#">A61H 2201/1481</a>
---	--------------------------------

### Informative references

*Attention is drawn to the following places, which may be of interest for search:*

Translation or oscillation resulting from magnetic field	<a href="#">A61H 23/0218</a>
Linear movement of interface	<a href="#">A61H 2201/1664</a>

## A61H 2201/1238

**with hydraulic or pneumatic drive**

## References

### Informative references

*Attention is drawn to the following places, which may be of interest for search:*

Pneumatic or hydraulic massage	<a href="#">A61H 9/00</a>
Vibration hydraulic or pneumatic driving means	<a href="#">A61H 23/04</a>
For active exercising	<a href="#">A63B 21/008</a>

## A61H 2201/1246

**by piston-cylinder systems**

## References

### Informative references

*Attention is drawn to the following places, which may be of interest for search:*

Hydraulic piston-cylinder for active exercising	<a href="#">A63B 21/0083</a>
Pneumatic piston-cylinder for active exercising	<a href="#">A63B 21/0087</a>

## A61H 2201/1253

**driven by a human being, e.g. hand driven**

## References

### Limiting references

*This place does not cover:*

Handheld or hand-driven device for rubbing or brushing	<a href="#">A61H 7/003</a>
Handheld suction-kneading massage, power driven	<a href="#">A61H 7/005</a>
Bladders inflated by user's body movement	<a href="#">A61H 9/0085</a>

Handheld massage by means of rollers, balls, power driven	<a href="#">A61H 15/0085</a>
Handheld massage by means of rollers, balls	<a href="#">A61H 15/0092</a>
Handheld	<a href="#">A61H 2201/0153</a>

### **Informative references**

*Attention is drawn to the following places, which may be of interest for search:*

Hand percussion	<a href="#">A61H 23/06</a>
-----------------	----------------------------

## **A61H 2201/1261**

**combined with active exercising of the patient**

### **References**

#### **Informative references**

*Attention is drawn to the following places, which may be of interest for search:*

Apparatus for passive exercising which can be used also for active exercising	<a href="#">A63B 21/00178</a>
---	-------------------------------

## **A61H 2201/1269**

**Passive exercise driven by movement of healthy limbs**

### **Definition statement**

*This place covers:*

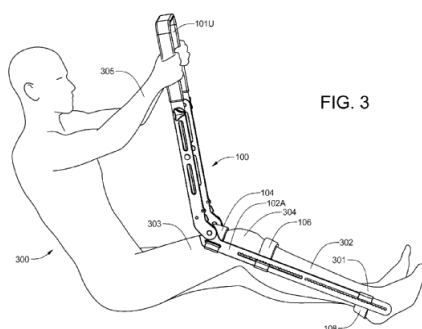

US2011224585

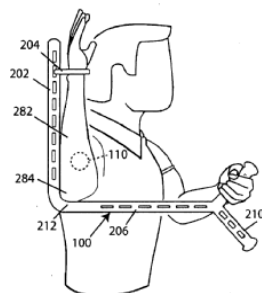
**A61H 2201/1276****by the other leg or arm****Definition statement***This place covers:*

US2008312053

**A61H 2201/1284****using own weight****References****Limiting references***This place does not cover:*

Bladders inflated by user's body movement	<a href="#">A61H 9/0085</a>
Using own weight for active exercising	<a href="#">A63B 21/00185</a>

**Informative references***Attention is drawn to the following places, which may be of interest for search:*

Traction table	<a href="#">A61H 1/0222</a>
Patient hanging	<a href="#">A61H 2203/0481</a>

**A61H 2201/1292****Therapy performed on humans by animals****Definition statement***This place covers:*

e.g. Fishes, shells, etc for skin treatment or horse-saddle with massage effect for a rider

**References****Limiting references***This place does not cover:*

Therapy specially adapted for being performed on animals	<a href="#">A61H 2203/03</a>
--	------------------------------

A61H 2201/14

Special force transmission means, i.e. between the driving means and the interface with the user

References

Limiting references

This place does not cover:

Driving means	<a href="#">A61H 2201/12</a>
Physical interface with the patient	<a href="#">A61H 2201/16</a>

A61H 2201/1409

Hydraulic or pneumatic means

References

Informative references

Attention is drawn to the following places, which may be of interest for search:

Hydraulic or pneumatic transmission means for active exercising	<a href="#">A63B 21/158</a>
---	-----------------------------

A61H 2201/1418

Cam

References

Informative references

Attention is drawn to the following places, which may be of interest for search:

Cam shaped pulleys transmission means for active exercising	<a href="#">A63B 21/155</a>
---	-----------------------------

A61H 2201/1427

Wobbling plate

Definition statement

This place covers:

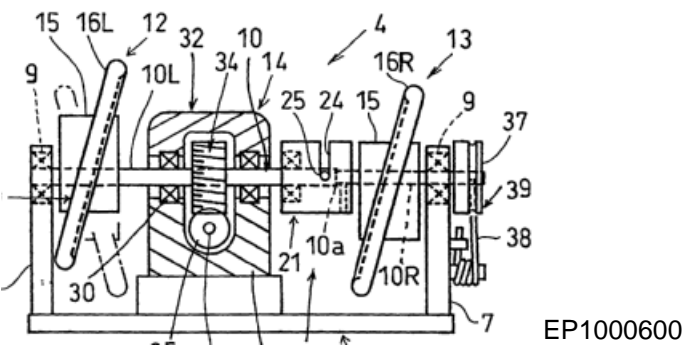

## References

### Limiting references

*This place does not cover:*

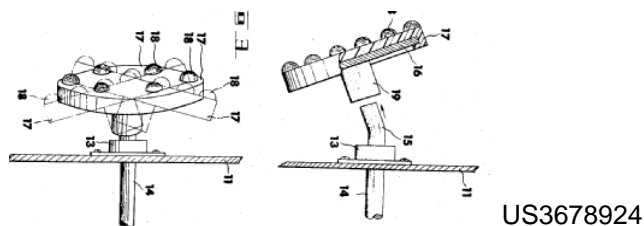

Wobbling movement of interface	<a href="#">A61H 2201/1661</a>
--------------------------------	--------------------------------

## A61H 2201/1436

### Special crank assembly

#### Definition statement

*This place covers:*

Specific applications of crank assemblies for massage and therapy devices

## A61H 2201/1445

### Overrunning clutches; One-way clutches

## References

### Informative references

*Attention is drawn to the following places, which may be of interest for search:*

For active exercising	<a href="#">A63B 21/157</a>
-----------------------	-----------------------------

## A61H 2201/1454

### Special bearing arrangements

#### Definition statement

*This place covers:*

e.g. bearings on both sides of a rotating unbalanced mass for stabilizing the structure

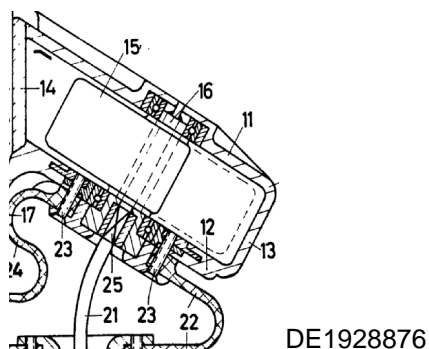

**A61H 2201/1463**

**Special speed variation means, i.e. speed reducer**

**Definition statement**

*This place covers:*  
Specific applications for massage and therapy devices

**A61H 2201/1472**

**Planetary gearing**

**Definition statement**

*This place covers:*

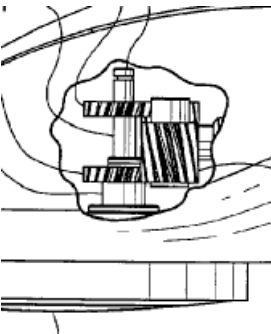

**A61H 2201/1481**

**Special movement conversion means**

**Definition statement**

*This place covers:*  
Specific applications for massage and therapy devices

**A61H 2201/149**

**rotation-linear or vice versa**

**References**

**Limiting references**

*This place does not cover:*

Single unit containing a itself rotary drive and a conversion system transforming the rotation in a linear movement	<a href="#">A61H 2201/123</a>
---	-------------------------------

**A61H 2201/16**

**Physical interface with patient**

**Definition statement**

*This place covers:*  
Interfaces implying an exchange of forces with the user

## References

### Informative references

Attention is drawn to the following places, which may be of interest for search:

Driving means	<a href="#">A61H 2201/12</a>
Special force transmission means	<a href="#">A61H 2201/14</a>
Electronic interface with the user	<a href="#">A61H 2201/5023</a>

## A61H 2201/1602

kind of interface, e.g. head rest, knee support or lumbar support

### Definition statement

*This place covers:*

Specific features of the interface with the patient

### Special rules of classification

Part of the body to be treated to be classified in [A61H 2205/00](#)

## A61H 2201/1604

Head

## References

### Informative references

Attention is drawn to the following places, which may be of interest for search:

Devices for treating head	<a href="#">A61H 2205/02</a>
Chairs with support for the head	<a href="#">A47C 7/38</a>
Beds, sofas or the like with support for the head	<a href="#">A47C 20/00</a>

## A61H 2201/1607

Holding means therefor

## References

### Limiting references

*This place does not cover:*

holding means for the head for active exercising	<a href="#">A63B 21/4003</a>
--	------------------------------



**A61H 2201/1609****Neck****References*****Informative references***

*Attention is drawn to the following places, which may be of interest for search:*

Devices for treating the neck	<a href="#">A61H 2205/04</a>
-------------------------------	------------------------------

**A61H 2201/1611****Holding means therefor****References*****Limiting references***

*This place does not cover:*

holding means for the neck for active exercising	<a href="#">A63B 21/4003</a>
--	------------------------------

**A61H 2201/1614****Shoulder, e.g. for neck stretching****References*****Informative references***

*Attention is drawn to the following places, which may be of interest for search:*

Devices for treating the shoulders	<a href="#">A61H 2205/062</a>
------------------------------------	-------------------------------

**A61H 2201/1616****Holding means therefor****References*****Limiting references***

*This place does not cover:*

holding means for the shoulders for active exercising	<a href="#">A63B 21/4005</a>
---	------------------------------

**A61H 2201/1619****Thorax****References****Informative references**

*Attention is drawn to the following places, which may be of interest for search:*

Devices for treating the thorax	<a href="#">A61H 2205/082</a> , <a href="#">A61H 2205/084</a>
---------------------------------	--

**A61H 2201/1621****Holding means therefor****References****Limiting references**

*This place does not cover:*

holding means for the chest/back for active exercising	<a href="#">A63B 21/4007</a>
--	------------------------------

**A61H 2201/1623****Back****References****Informative references**

*Attention is drawn to the following places, which may be of interest for search:*

Devices for treating the back	<a href="#">A61H 2205/081</a>
Chairs with support for the back	<a href="#">A47C 7/40</a>

**A61H 2201/1626****Holding means therefor****References****Limiting references**

*This place does not cover:*

holding means for the back for active exercising	<a href="#">A63B 21/4007</a>
--	------------------------------

**A61H 2201/1628****Pelvis****Definition statement***This place covers:*

Also waist

**References****Informative references***Attention is drawn to the following places, which may be of interest for search:*

Devices for treating the crotch	<a href="#">A61H 2205/085</a>
Devices for treating the buttocks	<a href="#">A61H 2205/086</a>
Devices for treating the genitals	<a href="#">A61H 2205/087</a>
Devices for treating the hip	<a href="#">A61H 2205/088</a>

**A61H 2201/163****holding means therefor****References****Limiting references***This place does not cover:*

holding means for the waist for active exercising	<a href="#">A63B 21/4009</a>
---	------------------------------

**A61H 2201/1633****Seat ([A61H 2201/0149](#) takes precedence)****References****Limiting references***This place does not cover:*

Benches for active exercising	<a href="#">A63B 21/4029</a>
-------------------------------	------------------------------

**Informative references***Attention is drawn to the following places, which may be of interest for search:*

Chairs	<a href="#">A47C 1/00</a>
--------	---------------------------

## A61H 2201/1635

Hand or arm, e.g. handle (hand-held, [A61H 2201/0153](#); fore-arm support, [A61H 2003/006](#))

### Definition statement

*This place covers:*

also handrails

### References

#### Informative references

*Attention is drawn to the following places, which may be of interest for search:*

Devices for treating the arms	<a href="#">A61H 2205/06</a>
Devices for treating the hands	<a href="#">A61H 2205/065</a>
Chairs with support for the arms	<a href="#">A47C 7/54</a>
Beds, sofas or the like with support for the arms	<a href="#">A47C 20/023</a>

## A61H 2201/1638

Holding means therefor

### References

#### Limiting references

*This place does not cover:*

holding means for the upper limb for active exercising	<a href="#">A63B 21/4017</a>
--	------------------------------

## A61H 2201/164

Feet or leg, e.g. pedal

### Definition statement

*This place covers:*

all parts of leg, e.g. knee

### References

#### Informative references

*Attention is drawn to the following places, which may be of interest for search:*

Devices for treating the legs	<a href="#">A61H 2205/10</a>
Chairs with support for the legs or feet	<a href="#">A47C 7/50</a>
Stand alone support for the legs or feet	<a href="#">A47C 16/00</a>
Beds, sofas or the like with support for the legs	<a href="#">A47C 20/021</a>

**A61H 2201/1642****Holding means therefor****References****Limiting references***This place does not cover:*

holding means for the lower limbs for active exercising	<a href="#">A63B 21/4011</a>
---	------------------------------

**A61H 2201/1645****contoured to fit the user****References****Informative references***Attention is drawn to the following places, which may be of interest for search:*

for active exercising	<a href="#">A63B 21/4039</a>
-----------------------	------------------------------

**A61H 2201/1647****the anatomy of a particular individual****References****Informative references***Attention is drawn to the following places, which may be of interest for search:*

Automatically adjusted according to anthropometric data of patient	<a href="#">A61H 2201/0196</a>
--	--------------------------------

**A61H 2201/165****Wearable interfaces****Definition statement***This place covers:*

interface to be worn and portable or attachable to a massaging or exercising device, i.e. a vest or a armband which can be used alone or attached to a machine and enables at least small movements of the user respect to the machine (NOT a band attached to a device and used for fixing a user to the device)

**References****Informative references***Attention is drawn to the following places, which may be of interest for search:*

Portable	<a href="#">A61H 2201/0157</a>
holding means for body specific parts	<a href="#">A61H 2201/1602</a>

A61H 2201/1652

Harness

Definition statement

*This place covers:*

A set of straps enabling the application of a force in at least one direction to a person carrying it without sliding-off, alone or within a garment

US7993248

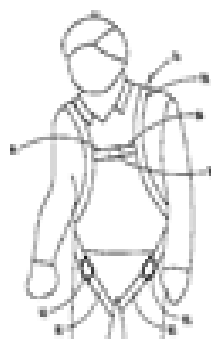

References

Informative references

*Attention is drawn to the following places, which may be of interest for search:*

Body harness	<a href="#">A62B 5/00</a>
--------------	---------------------------

A61H 2201/1654

Layer between the skin and massage elements, e.g. fluid or ball

Definition statement

*This place covers:*

To be used for all kind of massages, when a layer is used between the user and the massage elements, e.g. for protecting, for keeping dry, for distributing the force on the skin.

A61H 2201/1657

Movement of interface, i.e. force application means

Definition statement

*This place covers:*

Movement of the part of the device which is contact with the patient

References

Informative references

*Attention is drawn to the following places, which may be of interest for search:*

Electronic interface with the user	<a href="#">A61H 2201/5023</a>
------------------------------------	--------------------------------

A61H 2201/1659

Free spatial automatic movement of interface within a working area, e.g. Robot

Definition statement

This place covers:  
Three-dimensional movement freely programmable according to the needs

References

Informative references

Attention is drawn to the following places, which may be of interest for search:

Free movement of interface for active exercising	<a href="#">A63B 21/4043</a>
--	------------------------------

A61H 2201/1661

Wobbling interface, e.g. Stewart platform or Hexapod (nutating movement, [A61H 2001/0207](#))

Definition statement

This place covers:

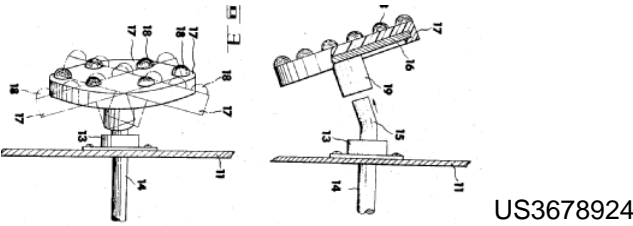

References

Limiting references

This place does not cover:

Nutating movement	<a href="#">A61H 2001/0207</a>
Wobbling plate as transmission means	<a href="#">A61H 2201/1427</a>

A61H 2201/1664

linear

References

Limiting references

This place does not cover:

knee and hip moved by translation	<a href="#">A61H 1/0259</a>
-----------------------------------	-----------------------------

**Informative references**

Attention is drawn to the following places, which may be of interest for search:

Linear drive	<a href="#">A61H 2201/123</a>
--------------	-------------------------------

**A61H 2201/1666**

multidimensional

**References****Informative references**

Attention is drawn to the following places, which may be of interest for search:

Free spatial automatic movement of interface	<a href="#">A61H 2201/1659</a>
--	--------------------------------

**A61H 2201/1669**

moving along the body in a reciprocating manner

**References****Informative references**

Attention is drawn to the following places, which may be of interest for search:

Physical interface contoured to fit the user	<a href="#">A61H 2201/1645</a>
Reciprocating interface for active exercising	<a href="#">A63B 21/4045</a>

**A61H 2201/1671**

rotational

**References****Limiting references**

This place does not cover:

Stretching or bending by rotating cycling movement	<a href="#">A61H 1/0214</a>
Massage by means of rollers, balls	<a href="#">A61H 15/00</a>

**Informative references**

Attention is drawn to the following places, which may be of interest for search:

Rotating interface for active exercising	<a href="#">A63B 21/4049</a>
--	------------------------------



**A61H 2201/1673****Multidimensional rotation****Definition statement**

*This place covers:*

Multiple axis of rotation

**A61H 2201/1676****Pivoting****References****Informative references**

*Attention is drawn to the following places, which may be of interest for search:*

Pivoting interface for active exercising	<a href="#">A63B 21/4047</a>
--	------------------------------

**A61H 2201/1678****Means for angularly oscillating massage elements****References****Informative references**

*Attention is drawn to the following places, which may be of interest for search:*

Control means	<a href="#">A61H 2201/50</a>
---------------	------------------------------

**A61H 2201/168****not moving****References****Informative references**

*Attention is drawn to the following places, which may be of interest for search:*

Active exercising device not moving during use	<a href="#">A63B 21/00047</a>
--	-------------------------------

**A61H 2201/1683****Surface of interface****References****Informative references**

*Attention is drawn to the following places, which may be of interest for search:*

Movement of interface	<a href="#">A61H 2201/1657</a>
-----------------------	--------------------------------

**A61H 2201/1685**

interchangeable (modular devices, [A61H 2201/0107](#))

**References****Informative references**

*Attention is drawn to the following places, which may be of interest for search:*

Modular	<a href="#">A61H 2201/0107</a>
---------	--------------------------------

**A61H 2201/1688**

disposable

**Definition statement**

*This place covers:*

e.g. disposable covers for the interface, to treat different users

**A61H 2201/169**

Physical characteristics of the surface, e.g. material, relief, texture or indicia

**References****Informative references**

*Attention is drawn to the following places, which may be of interest for search:*

Surface characteristics of the treading belt of a treadmill	<a href="#">A63B 22/0285</a>
---	------------------------------

**A61H 2201/1692**

Enhanced rubbing effect

**Definition statement**

*This place covers:*

e.g. texture

**References****Informative references**

*Attention is drawn to the following places, which may be of interest for search:*

Rubbing or brushing massages	<a href="#">A61H 7/002</a>
------------------------------	----------------------------

**A61H 2201/1697****Breathability of the material****References****Informative references***Attention is drawn to the following places, which may be of interest for search:*

Breathability of garments	<a href="#">A41D 31/102</a>
Breathable absorbent pads	<a href="#">A61F 13/51458</a>

**A61H 2201/50****Control means thereof****References****Informative references***Attention is drawn to the following places, which may be of interest for search:*

For active exercising	<a href="#">A63B 24/00</a>
-----------------------	----------------------------

**A61H 2201/5002****Means for controlling a set of similar massage devices acting in sequence at different locations on a patient****References****Informative references***Attention is drawn to the following places, which may be of interest for search:*

Intermittent or alternatively inflated bladders or cuffs	<a href="#">A61H 9/0078</a>
--	-----------------------------

**A61H 2201/5005****for controlling frequency distribution, modulation or interference of a driving signal****References****Informative references***Attention is drawn to the following places, which may be of interest for search:*

Frequency controlled AC motor	<a href="#">A61H 2201/1223</a>
-------------------------------	--------------------------------

**A61H 2201/5007****computer controlled****References****Informative references***Attention is drawn to the following places, which may be of interest for search:*

Free spatial automatic movement of interface	<a href="#">A61H 2201/1659</a>
--	--------------------------------

**A61H 2201/501****connected to external computer devices or networks****References****Informative references***Attention is drawn to the following places, which may be of interest for search:*

Wireless	<a href="#">A61H 2201/5097</a>
With means for remote communication for active exercising	<a href="#">A63B 2225/20</a>
Maintenance, remote assistance for active exercising	<a href="#">A63B 2225/305</a>
Wireless for active exercising	<a href="#">A63B 2225/50</a>

**A61H 2201/5012****using the internet****References****Informative references***Attention is drawn to the following places, which may be of interest for search:*

With means for remote communication for active exercising	<a href="#">A63B 2225/20</a>
---	------------------------------

**A61H 2201/5015****using specific interfaces or standards, e.g. USB, serial, parallel****References****Informative references***Attention is drawn to the following places, which may be of interest for search:*

With means for remote communication for active exercising	<a href="#">A63B 2225/20</a>
---	------------------------------

**A61H 2201/5017****Coin operated****References****Informative references***Attention is drawn to the following places, which may be of interest for search:*

Coin operated active exercising devices	<a href="#">A63B 2225/70</a>
---	------------------------------

**A61H 2201/502****Card operated, e.g. pre-paid card, credit card or ID card****References****Informative references***Attention is drawn to the following places, which may be of interest for search:*

Mechanisms actuated by objects other than coins	<a href="#">G07F 7/00</a>
---	---------------------------

**A61H 2201/5023****Interfaces to the user****Definition statement***This place covers:*

Control interfaces

**References****Limiting references***This place does not cover:*

Physical interface with the user	<a href="#">A61H 2201/16</a>
----------------------------------	------------------------------

**Informative references***Attention is drawn to the following places, which may be of interest for search:*

ICT specially adapted for the local operation of medical equipment or devices	<a href="#">G16H 40/63</a>
---	----------------------------

**A61H 2201/5025****Activation means****Definition statement***This place covers:*

Control activation means

**A61H 2201/5028**

**Contact activation, i.e. activated at contact with a surface of the user to be treated**

**References****Informative references**

*Attention is drawn to the following places, which may be of interest for search:*

Limit switches	<a href="#">A61H 2201/5066</a>
Contact switches for active exercise	<a href="#">A63B 2220/801</a>

**A61H 2201/503**

**Inertia activation, i.e. activated by movement**

**References****Informative references**

*Attention is drawn to the following places, which may be of interest for search:*

Switches operated by change of acceleration	<a href="#">H01H 35/14</a>
---	----------------------------

**A61H 2201/5033**

**having a fixed single program**

**Definition statement**

*This place covers:*

Basic devices having a controlling unit provided with a single program of use

**A61H 2201/5035**

**Several programs selectable**

**Definition statement**

*This place covers:*

Devices having a controlling unit provided with several programs of use

**A61H 2201/5038**

**freely programmable by the user**

**Definition statement**

*This place covers:*

Devices having a controlling unit programmable by the patient or the therapist

**A61H 2201/5041****control is restricted to certain individuals****References****Informative references***Attention is drawn to the following places, which may be of interest for search:*

Means for preventing injuries	<a href="#">A61H 2201/0173</a>
-------------------------------	--------------------------------

**A61H 2201/5043****Displays****References****Limiting references***This place does not cover:*

For active exercising	<a href="#">A63B 71/0622</a>
-----------------------	------------------------------

**A61H 2201/5046****Touch screens****References****Informative references***Attention is drawn to the following places, which may be of interest for search:*

Control panel with display for surgical instruments	<a href="#">A61B 2017/00199</a>
Touch screens for games	<a href="#">A63F 2009/241</a>

**A61H 2201/5048****Audio interfaces, e.g. voice or music controlled****References****Informative references***Attention is drawn to the following places, which may be of interest for search:*

For active exercising	<a href="#">A63B 71/0622</a>
Speech recognition	<a href="#">G10L 15/00</a>

**A61H 2201/5051****hydraulically controlled****References****Informative references***Attention is drawn to the following places, which may be of interest for search:*

Computer controlled	<a href="#">A61H 2201/5007</a>
---------------------	--------------------------------

**A61H 2201/5053****mechanically controlled****References****Informative references***Attention is drawn to the following places, which may be of interest for search:*

Computer controlled	<a href="#">A61H 2201/5007</a>
---------------------	--------------------------------

**A61H 2201/5056****pneumatically controlled****Definition statement***This place covers:*

Also specific pneumatic valves, e.g. mechanically rotated pneumatic valves for distributing air

**References****Informative references***Attention is drawn to the following places, which may be of interest for search:*

Computer controlled	<a href="#">A61H 2201/5007</a>
---------------------	--------------------------------

**A61H 2201/5058****Sensors or detectors****Definition statement***This place covers:*

For the control means

**References****Limiting references***This place does not cover:*

Sensors for the physical parameters of the user	<a href="#">A61H 2230/00</a>
---	------------------------------



**Informative references**

Attention is drawn to the following places, which may be of interest for search:

Arrangement of sensor for diagnostic	<a href="#">A61B 5/68</a>
--------------------------------------	---------------------------

**A61H 2201/5061****Force sensors****References****Informative references**

Attention is drawn to the following places, which may be of interest for search:

For active exercising	<a href="#">A63B 2220/50</a>
-----------------------	------------------------------

**A61H 2201/5064****Position sensors****References****Informative references**

Attention is drawn to the following places, which may be of interest for search:

For active exercising	<a href="#">A63B 2220/10</a>
-----------------------	------------------------------

**A61H 2201/5066****Limit switches****References****Informative references**

Attention is drawn to the following places, which may be of interest for search:

Relative position sensors for active exercising	<a href="#">A63B 2220/13</a>
---	------------------------------

**A61H 2201/5069****Angle sensors****References****Informative references**

Attention is drawn to the following places, which may be of interest for search:

Angular position sensor for active exercising	<a href="#">A63B 2220/24</a>
Angular speed sensor for active exercising	<a href="#">A63B 2220/34</a>
Angular acceleration sensor for active exercising	<a href="#">A63B 2220/44</a>

**A61H 2201/5071****Pressure sensors****References****Informative references**

*Attention is drawn to the following places, which may be of interest for search:*

For active exercising	<a href="#">A63B 2220/56</a>
-----------------------	------------------------------

**A61H 2201/5074****using electric pressure transducers with proportional output****References****Informative references**

*Attention is drawn to the following places, which may be of interest for search:*

Sensors for measuring force related parameters by electric or magnetic means, for active exercising	<a href="#">A63B 2220/58</a>
---	------------------------------

**A61H 2201/5076****Frequency sensors****References****Informative references**

*Attention is drawn to the following places, which may be of interest for search:*

For active exercising	<a href="#">A63B 2220/64</a>
-----------------------	------------------------------

**A61H 2201/5079****Velocity sensors****References****Informative references**

*Attention is drawn to the following places, which may be of interest for search:*

For active exercising	<a href="#">A63B 2220/30</a>
-----------------------	------------------------------

**A61H 2201/5082****Temperature sensors****References****Informative references**

*Attention is drawn to the following places, which may be of interest for search:*

For active exercising	<a href="#">A63B 2220/72</a>
-----------------------	------------------------------

**A61H 2201/5084****Acceleration sensors****References****Informative references**

*Attention is drawn to the following places, which may be of interest for search:*

For active exercising	<a href="#">A63B 2220/40</a>
-----------------------	------------------------------

**A61H 2201/5087****Flow rate sensors****References****Informative references**

*Attention is drawn to the following places, which may be of interest for search:*

Hydraulic massage	<a href="#">A61H 9/0021</a>
Hydraulic or pneumatic drive	<a href="#">A61H 2201/1238</a>

**A61H 2201/5089****Gas sensors, e.g. for oxygen or CO<sub>2</sub>****References****Informative references**

*Attention is drawn to the following places, which may be of interest for search:*

Pneumatic massage	<a href="#">A61H 9/005</a>
Hydraulic or pneumatic drive	<a href="#">A61H 2201/1238</a>

**A61H 2201/5092****Optical sensor****References****Informative references**

*Attention is drawn to the following places, which may be of interest for search:*

For active exercising	<a href="#">A63B 2220/805</a>
-----------------------	-------------------------------

**A61H 2201/5094****with patient markers****References****Informative references**

*Attention is drawn to the following places, which may be of interest for search:*

Image processing for measuring for active exercising	<a href="#">A63B 2220/05</a>
Sensors on the body of the user for active exercising	<a href="#">A63B 2220/836</a>

**A61H 2201/5097****wireless****References****Informative references**

*Attention is drawn to the following places, which may be of interest for search:*

Bathing or washing devices using remote control signals	<a href="#">A61H 2033/0079</a>
With means for remote communication for active exercising	<a href="#">A63B 2225/20</a>
Maintenance, remote assistance for active exercising	<a href="#">A63B 2225/305</a>
Wireless for active exercising	<a href="#">A63B 2225/50</a>

**A61H 2203/00****Additional characteristics concerning the patient****Definition statement**

*This place covers:*

Classes which are used for specifying the details concerning the patient not defined in the preceding scheme

**A61H 2203/02****immersed in liquid****References****Informative references***Attention is drawn to the following places, which may be of interest for search:*

Body floating supports for relaxation in water	<a href="#">A61H 37/005</a>
Device used in water	<a href="#">A61H 2201/0115</a>
User immersed in water for active exercising	<a href="#">A63B 2208/03</a>
Device used in water for active exercising	<a href="#">A63B 2225/60</a>

**A61H 2203/03****especially adapted for animals****References****Informative references***Attention is drawn to the following places, which may be of interest for search:*

for active exercising	<a href="#">A63B 2208/14</a>
-----------------------	------------------------------

**A61H 2203/04****Position of the patient****References****Informative references***Attention is drawn to the following places, which may be of interest for search:*

for active exercising	<a href="#">A63B 2208/02</a>
-----------------------	------------------------------

**A61H 2203/0406****Standing on the feet****References****Informative references***Attention is drawn to the following places, which may be of interest for search:*

For active exercising	<a href="#">A63B 2208/0204</a>
-----------------------	--------------------------------

**A61H 2203/0412****Kneeling****References****Informative references**

*Attention is drawn to the following places, which may be of interest for search:*

For active exercising	<a href="#">A63B 2208/0214</a>
-----------------------	--------------------------------

**A61H 2203/0418****Squatting, i.e. sitting on the heels****References****Informative references**

*Attention is drawn to the following places, which may be of interest for search:*

For active exercising	<a href="#">A63B 2208/0223</a>
-----------------------	--------------------------------

**A61H 2203/0425****Sitting on the buttocks****References****Informative references**

*Attention is drawn to the following places, which may be of interest for search:*

For active exercising	<a href="#">A63B 2208/0228</a>
-----------------------	--------------------------------

**A61H 2203/0431****in 90°/90°-position, like on a chair****References****Informative references**

*Attention is drawn to the following places, which may be of interest for search:*

For active exercising	<a href="#">A63B 2208/0233</a>
-----------------------	--------------------------------

**A61H 2203/0437****with stretched legs, like in a bed****References****Informative references**

*Attention is drawn to the following places, which may be of interest for search:*

for active exercising	<a href="#">A63B 2208/0238</a>
-----------------------	--------------------------------

**A61H 2203/0443****substantially horizontal****References****Informative references***Attention is drawn to the following places, which may be of interest for search:*

For active exercising	<a href="#">A63B 2208/0242</a>
-----------------------	--------------------------------

**A61H 2203/045****with legs in a kneeled 90°/90°-position****References****Informative references***Attention is drawn to the following places, which may be of interest for search:*

For active exercising	<a href="#">A63B 2208/0247</a>
-----------------------	--------------------------------

**A61H 2203/0456****Supine****References****Informative references***Attention is drawn to the following places, which may be of interest for search:*

For active exercising	<a href="#">A63B 2208/0252</a>
-----------------------	--------------------------------

**A61H 2203/0462****with legs stretched and hips in 90°-position****Definition statement***This place covers:*

Torso being substantially horizontal and the legs being perpendicular to the torso

**A61H 2203/0468****Prone****References****Informative references***Attention is drawn to the following places, which may be of interest for search:*

For active exercising	<a href="#">A63B 2208/0257</a>
-----------------------	--------------------------------

**A61H 2203/0475****on the side****References****Informative references***Attention is drawn to the following places, which may be of interest for search:*

For active exercising	<a href="#">A63B 2208/0266</a>
-----------------------	--------------------------------

**A61H 2203/0481****Hanging****References****Informative references***Attention is drawn to the following places, which may be of interest for search:*

For active exercising	<a href="#">A63B 2208/0285</a>
-----------------------	--------------------------------

**A61H 2203/0487****upright****References****Informative references***Attention is drawn to the following places, which may be of interest for search:*

For active exercising	<a href="#">A63B 2208/029</a>
-----------------------	-------------------------------

**A61H 2203/0493****by hanging the patient upside down or inclined downwardly****References****Informative references***Attention is drawn to the following places, which may be of interest for search:*

Drawing-out devices	<a href="#">A61H 1/0218</a>
---------------------	-----------------------------



## A61H 2205/00

Devices for specific parts of the body ([A61H 1/02](#), [A61H 13/00](#), [A61H 19/00](#), [A61H 21/00](#), [A61H 35/00](#) take precedence)

### References

#### Limiting references

*This place does not cover:*

Stretching or bending specific body parts	<a href="#">A61H 1/02</a>
Gum massage	<a href="#">A61H 13/00</a>
Massage of the genitals	<a href="#">A61H 19/00</a>
Massage devices for cavities of the body (nose, ears, anus)	<a href="#">A61H 21/00</a>
Bath for specific body parts	<a href="#">A61H 35/00</a>

### Special rules of classification

Part of the body interfaced with the device to be classified in [A61H 2201/1602](#)

## A61H 2205/02

### Head

### References

#### Informative references

*Attention is drawn to the following places, which may be of interest for search:*

Bath therefor	<a href="#">A61H 35/008</a>
Support for the head	<a href="#">A61H 2201/1604</a>

## A61H 2205/021

### Scalp

### References

#### Informative references

*Attention is drawn to the following places, which may be of interest for search:*

Support for the head	<a href="#">A61H 2201/1604</a>
Preparations for care of the skin	<a href="#">A61Q 19/00</a>

A61H 2205/022

Face

References

Informative references

Attention is drawn to the following places, which may be of interest for search:

Support for the head	<a href="#">A61H 2201/1604</a>
----------------------	--------------------------------

A61H 2205/023

Nose

References

Informative references

Attention is drawn to the following places, which may be of interest for search:

Bath therefor	<a href="#">A61H 35/04</a>
Support for the head	<a href="#">A61H 2201/1604</a>

A61H 2205/024

Eyes

References

Informative references

Attention is drawn to the following places, which may be of interest for search:

Bath therefor	<a href="#">A61H 35/02</a>
Support for the head	<a href="#">A61H 2201/1604</a>

A61H 2205/025

Forehead

References

Informative references

Attention is drawn to the following places, which may be of interest for search:

Support for the head	<a href="#">A61H 2201/1604</a>
----------------------	--------------------------------

**A61H 2205/026****Mandible****References****Informative references**

*Attention is drawn to the following places, which may be of interest for search:*

Support for the head	<a href="#">A61H 2201/1604</a>
----------------------	--------------------------------

**A61H 2205/027****Ears****References****Informative references**

*Attention is drawn to the following places, which may be of interest for search:*

Support for the head	<a href="#">A61H 2201/1604</a>
----------------------	--------------------------------

**A61H 2205/028****Temples****References****Informative references**

*Attention is drawn to the following places, which may be of interest for search:*

Support for the head	<a href="#">A61H 2201/1604</a>
----------------------	--------------------------------

**A61H 2205/04****neck****References****Informative references**

*Attention is drawn to the following places, which may be of interest for search:*

Support for the neck	<a href="#">A61H 2201/1609</a>
----------------------	--------------------------------

**A61H 2205/06****Arms****References****Informative references**

*Attention is drawn to the following places, which may be of interest for search:*

Support for the arm or hand	<a href="#">A61H 2201/1635</a>
-----------------------------	--------------------------------

**A61H 2205/062****Shoulders****References****Informative references**

*Attention is drawn to the following places, which may be of interest for search:*

Support for the shoulders	<a href="#">A61H 2201/1614</a>
---------------------------	--------------------------------

**A61H 2205/065****Hands****References****Informative references**

*Attention is drawn to the following places, which may be of interest for search:*

Support for the arm or hand	<a href="#">A61H 2201/1635</a>
-----------------------------	--------------------------------

**A61H 2205/067****Fingers****References****Informative references**

*Attention is drawn to the following places, which may be of interest for search:*

Support for the arm or hand	<a href="#">A61H 2201/1635</a>
-----------------------------	--------------------------------

**A61H 2205/08****Trunk****References****Informative references**

*Attention is drawn to the following places, which may be of interest for search:*

Support for the thorax	<a href="#">A61H 2201/1619</a>
------------------------	--------------------------------

**A61H 2205/081****Back****References****Informative references**

*Attention is drawn to the following places, which may be of interest for search:*

Support for the back	<a href="#">A61H 2201/1623</a>
----------------------	--------------------------------

**A61H 2205/082****Breasts****References****Informative references**

*Attention is drawn to the following places, which may be of interest for search:*

Bath therefor	<a href="#">A61H 35/002</a>
Support for the thorax	<a href="#">A61H 2201/1619</a>

**A61H 2205/083****Abdomen****References****Informative references**

*Attention is drawn to the following places, which may be of interest for search:*

Support for the thorax	<a href="#">A61H 2201/1619</a>
------------------------	--------------------------------

**A61H 2205/084****Chest****References****Informative references**

*Attention is drawn to the following places, which may be of interest for search:*

Support for the thorax	<a href="#">A61H 2201/1619</a>
------------------------	--------------------------------

**A61H 2205/085****Crotch****References****Informative references**

*Attention is drawn to the following places, which may be of interest for search:*

Support for the pelvis	<a href="#">A61H 2201/1628</a>
------------------------	--------------------------------

**A61H 2205/086****Buttocks****References*****Informative references***

*Attention is drawn to the following places, which may be of interest for search:*

Support for the pelvis	<a href="#">A61H 2201/1628</a>
------------------------	--------------------------------

**A61H 2205/087****Genitals****References*****Limiting references***

*This place does not cover:*

Massage for the genitals	<a href="#">A61H 19/00</a>
--------------------------	----------------------------

***Informative references***

*Attention is drawn to the following places, which may be of interest for search:*

Support for the pelvis	<a href="#">A61H 2201/1628</a>
------------------------	--------------------------------

**A61H 2205/088****Hip****References*****Informative references***

*Attention is drawn to the following places, which may be of interest for search:*

Support for the pelvis	<a href="#">A61H 2201/1628</a>
------------------------	--------------------------------

**A61H 2205/10****Leg****References*****Informative references***

*Attention is drawn to the following places, which may be of interest for search:*

Support for the feet or leg	<a href="#">A61H 2201/164</a>
-----------------------------	-------------------------------

**A61H 2205/102****Knee****References****Informative references***Attention is drawn to the following places, which may be of interest for search:*

Support for the feet or leg	<a href="#">A61H 2201/164</a>
-----------------------------	-------------------------------

**A61H 2205/104****Patella****References****Informative references***Attention is drawn to the following places, which may be of interest for search:*

Support for the feet or leg	<a href="#">A61H 2201/164</a>
-----------------------------	-------------------------------

**A61H 2205/106****for the lower legs****References****Informative references***Attention is drawn to the following places, which may be of interest for search:*

Support for the feet or leg	<a href="#">A61H 2201/164</a>
-----------------------------	-------------------------------

**A61H 2205/108****for the upper legs****References****Informative references***Attention is drawn to the following places, which may be of interest for search:*

Support for the feet or leg	<a href="#">A61H 2201/164</a>
-----------------------------	-------------------------------

**A61H 2205/12****Feet****References****Informative references***Attention is drawn to the following places, which may be of interest for search:*

Bath therefore	<a href="#">A61H 35/006</a>
----------------	-----------------------------

Support for the feet or leg	<a href="#">A61H 2201/164</a>
-----------------------------	-------------------------------

## A61H 2205/125

### Foot reflex zones

#### References

##### Informative references

Attention is drawn to the following places, which may be of interest for search:

Devices for locating or stimulating specific reflex points	<a href="#">A61H 39/00</a>
Support for the feet or leg	<a href="#">A61H 2201/164</a>

## A61H 2207/00

### Anti-cellulite devices

#### References

##### Informative references

Attention is drawn to the following places, which may be of interest for search:

Specific parts of the body to be treated	<a href="#">A61H 2205/00</a>
--	------------------------------

## A61H 2209/00

### Devices for avoiding blood stagnation, e.g. Deep Vein Thrombosis [DVT] devices

#### References

##### Informative references

Attention is drawn to the following places, which may be of interest for search:

Active exercises therefore	<a href="#">A63B 2022/0097</a>
----------------------------	--------------------------------



[illegible]

This chart is meant to help a classifier to find the main classes. For the complete classification please refer to CPC and Definitions.  
\*: a star denotes a class over which at least another class takes precedence

Physical therapy  
Sheet 1/4

Massages

Bath, Spa  
Sauna  
Sheet 1/4

Artificial respiration,  
Heart massage  
A61H31/00  
Sheet 1/4

Suction-Kneading  
A61H7/00

No movement  
A61H7/001 \*

Rubbing/brushing  
A61H7/002

Helmets  
A61H7/006 \*

Kneading  
A61H7/007

Hand-held/driven  
A61H7/003 \*

Power driven  
A61H7/004 \*

hand-held  
A61H7/005

Suction kneading  
A61H7/008

Parallel axis massage elements  
A61H2007/009

Pneumatic or Hydraulic  
A61H9/00 \*

Pulsating  
A61H9/0007

With particles  
A61H2009/0014

Hydraulic  
A61H9/0021

Pneumatic  
A61H9/005 \*

Hand-held  
A61H9/0028 \*

Cabin for the whole body  
A61H2009/0035

Water recirculation  
A61H2009/0042 \*

Suction  
A61H9/0057

Without further vacuum source  
A61H2009/0064

Air stream/jets  
A61H9/0071 \*

Alternately inflated cuffs  
A61H9/0078 \*

by user movement  
A61H9/0085

Cuffs therefore  
A61H9/0092

Genitals  
A61H19/00 \*

Belt, strips or combs  
A61H11/00

Around an encried body part  
A61H2011/005

With oscillating strips  
A61H11/02 \*

Indexing kind of roller  
A61H2015/0007-0071

Power-driven  
A61H15/0078 \*

hand-held  
A61H15/0085

Hand-held  
A61H15/0092

+ light, heat, drugs  
A61H15/02

Gum  
A61H13/00

Hydraulic  
A61H13/005

Rollers, balls, chains  
A61H15/00

Percussions, Vibrations  
A61H23/00 \*

Mechanical drive  
A61H23/004

Percussion/tapping  
A61H23/006

Shock waves  
A61H23/008 \*

Electric/magnetic  
A61H23/02

With passive spacer element  
A61H2023/002

Hand percussion  
A61H23/06 \*

Hydraulic/pneum.  
A61H23/04

External stimulation  
A61H19/30

Sexual intercourse  
A61H19/50

Insertable  
A61H19/40

Genitals inserted  
A61H19/32

Clitoral stimulation  
A61H19/34

Cylindrical shape  
A61H19/44

Frequencies not related to mains frequency  
A61H2023/0209

Alternating fields  
A61H23/0218

Ultrasonic transd  
A61H23/0245 \*

Rotary motor  
A61H23/0254 \*

Using hydrostatic pressure  
A61H2023/045

sonic waves  
A61H23/0236 \*

Magnetostriuctive elements  
A61H2023/0227 \*

Unbalanced masses  
A61H23/0263 \*

Indexing  
A61H2023/0272-029

Cavities  
A61H21/00 \*

Accessories  
A61H37/00

Floating supports  
A61H37/005 \*

Reflex points  
A61H39/00

electric currents  
A61H39/002

Mechanical vibration  
A61H39/007

For locating the points  
A61H39/02

For pressing the points  
A61H39/04 \*

For heat/cool the points  
A61H39/06

Applying needles  
A61H39/08

Electromagnetic waves  
A61H2039/005

Needle tubes  
A61H39/083

Acupuncture needles  
A61H39/086

A61H

Sheet 2/4

## Informative references

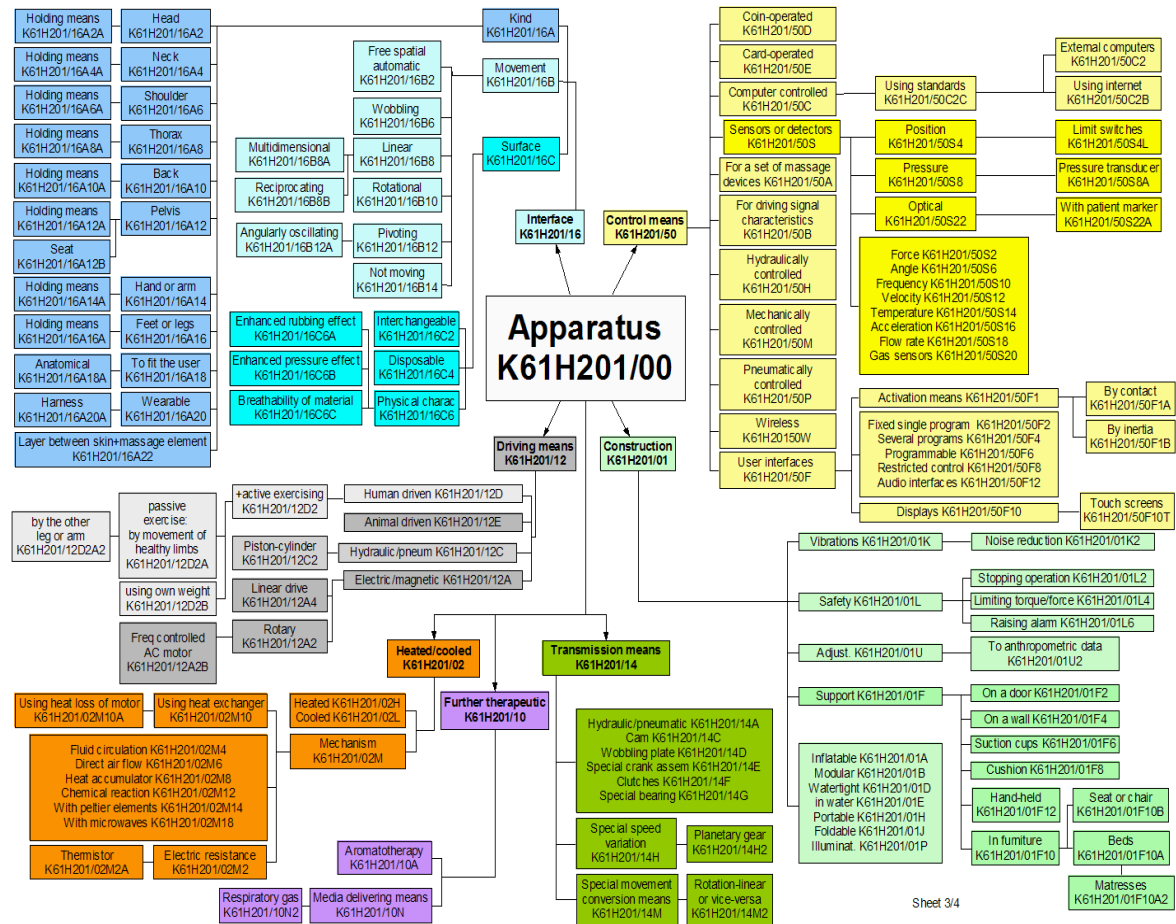

Sheet 3/4

## Informative references

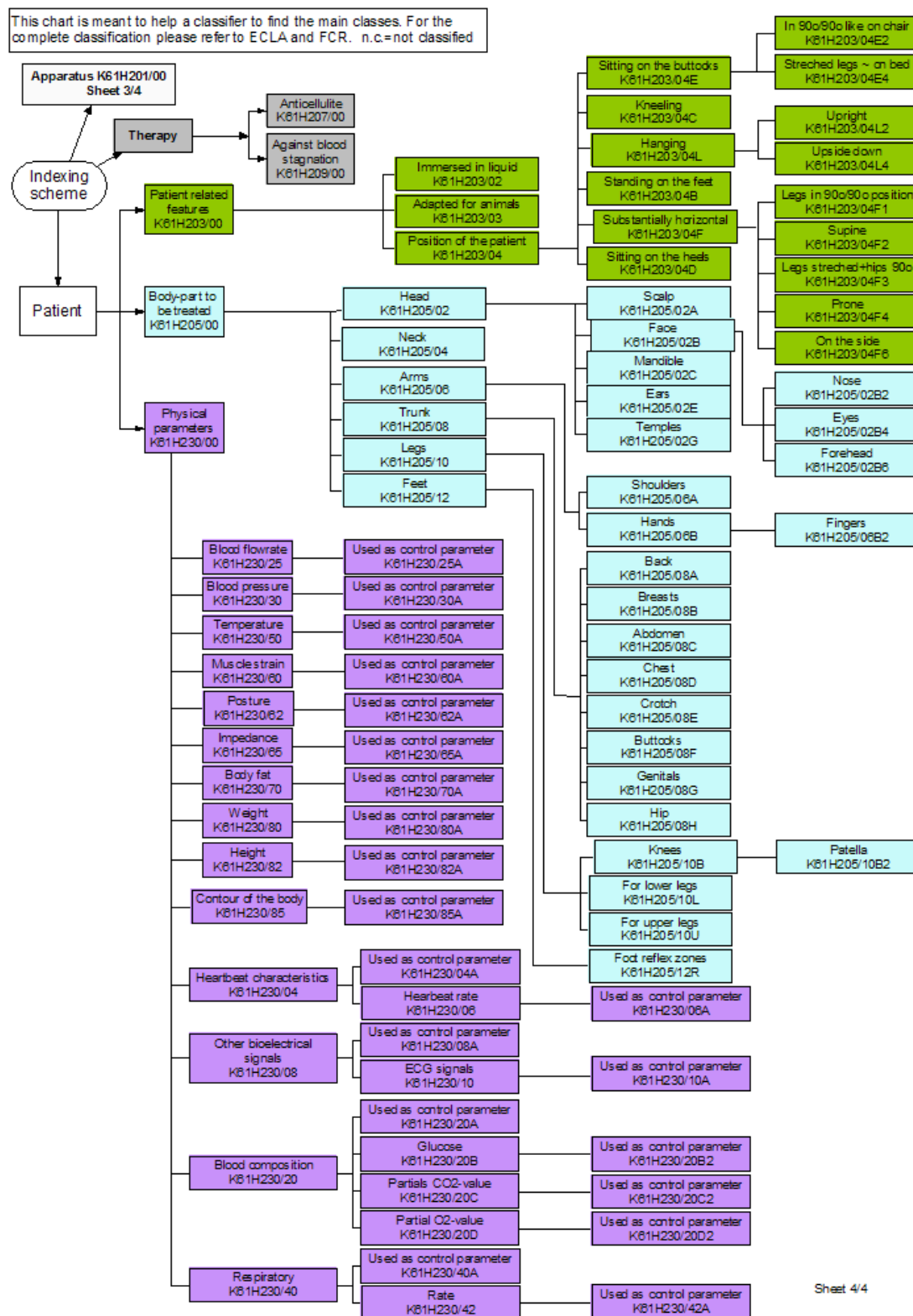

**A61H 2230/00****Measuring physical parameters of the user****References****Informative references***Attention is drawn to the following places, which may be of interest for search:*

For active exercising	<a href="#">A63B 2230/00</a>
-----------------------	------------------------------

**A61H 2230/04****Heartbeat characteristics, e.g. E.G.C., blood pressure modulation****References****Informative references***Attention is drawn to the following places, which may be of interest for search:*

Measuring blood flow parameters	<a href="#">A61B 5/02</a>
For active exercising	<a href="#">A63B 2230/04</a>

**A61H 2230/045****used as a control parameter for the apparatus****References****Informative references***Attention is drawn to the following places, which may be of interest for search:*

For active exercising	<a href="#">A63B 2230/045</a>
-----------------------	-------------------------------

**A61H 2230/06****Heartbeat rate****References****Informative references***Attention is drawn to the following places, which may be of interest for search:*

Measuring pulse rate or heart rate	<a href="#">A61B 5/024</a>
For active exercising	<a href="#">A63B 2230/06</a>

**A61H 2230/065**

used as a control parameter for the apparatus

**References****Informative references**

Attention is drawn to the following places, which may be of interest for search:

For active exercising	<a href="#">A63B 2230/062</a>
-----------------------	-------------------------------

**A61H 2230/08**

Other bio-electrical signals

**References****Informative references**

Attention is drawn to the following places, which may be of interest for search:

For active exercising	<a href="#">A63B 2230/08</a>
-----------------------	------------------------------

**A61H 2230/085**

used as a control parameter for the apparatus

**References****Informative references**

Attention is drawn to the following places, which may be of interest for search:

For active exercising	<a href="#">A63B 2230/085</a>
-----------------------	-------------------------------

**A61H 2230/10**

Electroencephalographic signals

**References****Informative references**

Attention is drawn to the following places, which may be of interest for search:

For active exercising	<a href="#">A63B 2230/10</a>
-----------------------	------------------------------

**A61H 2230/105**

used as a control parameter for the apparatus

**References****Informative references**

Attention is drawn to the following places, which may be of interest for search:

For active exercising	<a href="#">A63B 2230/105</a>
-----------------------	-------------------------------

**A61H 2230/20****Blood composition characteristics****References****Informative references***Attention is drawn to the following places, which may be of interest for search:*

For active exercising	<a href="#">A63B 2230/20</a>
-----------------------	------------------------------

**A61H 2230/201****used as a control parameter for the apparatus****References****Informative references***Attention is drawn to the following places, which may be of interest for search:*

For active exercising	<a href="#">A63B 2230/201</a>
-----------------------	-------------------------------

**A61H 2230/202****Glucose****References****Informative references***Attention is drawn to the following places, which may be of interest for search:*

For active exercising	<a href="#">A63B 2230/202</a>
-----------------------	-------------------------------

**A61H 2230/203****used as a control parameter for the apparatus****References****Informative references***Attention is drawn to the following places, which may be of interest for search:*

For active exercising	<a href="#">A63B 2230/203</a>
-----------------------	-------------------------------

**A61H 2230/205****partial CO<sub>2</sub>-value****References****Informative references***Attention is drawn to the following places, which may be of interest for search:*

For active exercising	<a href="#">A63B 2230/205</a>
-----------------------	-------------------------------

**A61H 2230/206****used as a control parameter for the apparatus****References****Informative references***Attention is drawn to the following places, which may be of interest for search:*

For active exercising	<a href="#">A63B 2230/206</a>
-----------------------	-------------------------------

**A61H 2230/207****partial O<sub>2</sub>-value****References****Informative references***Attention is drawn to the following places, which may be of interest for search:*

For active exercising	<a href="#">A63B 2230/207</a>
-----------------------	-------------------------------

**A61H 2230/208****used as a control parameter for the apparatus****References****Informative references***Attention is drawn to the following places, which may be of interest for search:*

For active exercising	<a href="#">A63B 2230/208</a>
-----------------------	-------------------------------

**A61H 2230/25****Blood flowrate, e.g. by Doppler effect****References****Informative references***Attention is drawn to the following places, which may be of interest for search:*

Measuring blood flow	<a href="#">A61B 5/026</a>
Measuring blood composition for active exercising	<a href="#">A63B 2230/20</a>

**A61H 2230/255**

used as a control parameter for the apparatus

**References****Informative references**

Attention is drawn to the following places, which may be of interest for search:

Measuring blood composition for active exercising	<a href="#">A63B 2230/201</a>
---	-------------------------------

**A61H 2230/30**

Blood pressure ([A61H 2230/04](#) takes precedence)

**References****Informative references**

Attention is drawn to the following places, which may be of interest for search:

Measuring blood pressures	<a href="#">A61B 5/021</a>
For active exercising	<a href="#">A63B 2230/30</a>

**A61H 2230/305**

used as a control parameter for the apparatus ([A61H 2230/045](#) takes precedence)

**References****Informative references**

Attention is drawn to the following places, which may be of interest for search:

For active exercising	<a href="#">A63B 2230/305</a>
-----------------------	-------------------------------

**A61H 2230/40**

Respiratory characteristics

**References****Informative references**

Attention is drawn to the following places, which may be of interest for search:

For active exercising	<a href="#">A63B 2230/40</a>
-----------------------	------------------------------



**A61H 2230/405**

used as a control parameter for the apparatus

**References****Informative references**

Attention is drawn to the following places, which may be of interest for search:

For active exercising	<a href="#">A63B 2230/405</a>
-----------------------	-------------------------------

**A61H 2230/42**

Rate

**References****Informative references**

Attention is drawn to the following places, which may be of interest for search:

For active exercising	<a href="#">A63B 2230/42</a>
-----------------------	------------------------------

**A61H 2230/425**

used as a control parameter for the apparatus

**References****Informative references**

Attention is drawn to the following places, which may be of interest for search:

For active exercising	<a href="#">A63B 2230/425</a>
-----------------------	-------------------------------

**A61H 2230/50**

Temperature

**References****Informative references**

Attention is drawn to the following places, which may be of interest for search:

For active exercising	<a href="#">A63B 2230/50</a>
-----------------------	------------------------------

**A61H 2230/505**

used as a control parameter for the apparatus

**References****Informative references**

Attention is drawn to the following places, which may be of interest for search:

For active exercising	<a href="#">A63B 2230/505</a>
-----------------------	-------------------------------

**A61H 2230/60**

**Muscle strain, i.e. measured on the user, e.g. Electromyography [EMG]**

**Definition statement**

*This place covers:*  
muscle activity

**References**

**Informative references**

*Attention is drawn to the following places, which may be of interest for search:*

For active exercising	<a href="#">A63B 2230/60</a>
-----------------------	------------------------------

**A61H 2230/605**

**used as a control parameter for the apparatus**

**References**

**Informative references**

*Attention is drawn to the following places, which may be of interest for search:*

For active exercising	<a href="#">A63B 2230/605</a>
-----------------------	-------------------------------

**A61H 2230/62**

**Posture**

**References**

**Informative references**

*Attention is drawn to the following places, which may be of interest for search:*

For active exercising	<a href="#">A63B 2230/62</a>
-----------------------	------------------------------

**A61H 2230/625**

**used as a control parameter for the apparatus**

**References**

**Informative references**

*Attention is drawn to the following places, which may be of interest for search:*

For active exercising	<a href="#">A63B 2230/625</a>
-----------------------	-------------------------------

**A61H 2230/65**

Impedance, e.g. skin conductivity; capacitance, e.g. galvanic skin response [GSR]

**References****Informative references**

Attention is drawn to the following places, which may be of interest for search:

For active exercising	<a href="#">A63B 2230/65</a>
-----------------------	------------------------------

**A61H 2230/655**

used as a control parameter for the apparatus

**References****Informative references**

Attention is drawn to the following places, which may be of interest for search:

For active exercising	<a href="#">A63B 2230/655</a>
-----------------------	-------------------------------

**A61H 2230/70**

Body fat

**References****Informative references**

Attention is drawn to the following places, which may be of interest for search:

For active exercising	<a href="#">A63B 2230/70</a>
-----------------------	------------------------------

**A61H 2230/705**

used as a control parameter for the apparatus

**References****Informative references**

Attention is drawn to the following places, which may be of interest for search:

For active exercising	<a href="#">A63B 2230/705</a>
-----------------------	-------------------------------

**A61H 2230/80****Weight****References****Informative references***Attention is drawn to the following places, which may be of interest for search:*

For active exercising	<a href="#">A63B 2230/01</a>
-----------------------	------------------------------

**A61H 2230/805****used as a control parameter for the apparatus****References****Informative references***Attention is drawn to the following places, which may be of interest for search:*

For active exercising	<a href="#">A63B 2230/015</a>
-----------------------	-------------------------------

**A61H 2230/82****Height, e.g. length****References****Informative references***Attention is drawn to the following places, which may be of interest for search:*

Setting of device automatically adjusted according to anthropometric data of the user	<a href="#">A61H 2201/0196</a>
---	--------------------------------

**A61H 2230/825****used as a control parameter for the apparatus****References****Informative references***Attention is drawn to the following places, which may be of interest for search:*

Setting of device automatically adjusted according to anthropometric data of the user	<a href="#">A61H 2201/0196</a>
---	--------------------------------

**A61H 2230/85****Contour of the body****References*****Informative references***

*Attention is drawn to the following places, which may be of interest for search:*

Setting of device automatically adjusted according to anthropometric data of the user	<a href="#">A61H 2201/0196</a>
Contoured to fit the user	<a href="#">A61H 2201/1645</a>

**A61H 2230/855****used as a control parameter for the apparatus****References*****Informative references***

*Attention is drawn to the following places, which may be of interest for search:*

Setting of device automatically adjusted according to anthropometric data of the user	<a href="#">A61H 2201/0196</a>
---	--------------------------------